

Universal Throttle & Shift Cables

Features:

- Universal cables meet all specifications for 33/3300, 43/4300 or 64/6400 type original equipment cables.
- Cables can use the existing connection components.
- Stainless steel and brass fittings.
- **Standard cables** use stainless steel Lubri-Core™ core wire for smooth operation and long life. (6" minimum bend radius.)
- **Midrange cables** use a heavier jacket and either stainless steel Lubri-Core™ or a coated cable (33C Supreme) core wire. (6" minimum bend radius.)
- **TFXTREME® premium 3300 cables** have a heavy jacket and a splined, coated core element for maximum smoothness with minimal lost motion. (4" min. bend radius.)
- **4300 type cables** have stainless steel conduit fittings. (5" minimum bend radius.)
- **6400 type cables** have stainless steel conduit fittings. (8" minimum bend radius.)
- Black HDPE outer casing for durability and best resistance to UV and chemicals.
- Cables meet/exceed all applicable industry standards.

Applications:

Universal type cables are designed to fit aftermarket engine controls as well as OEM units from BMW®, Chrysler®, Honda®, Nissan®, Suzuki®, Volvo®, Yamaha® and others. Five versions of the 33C type are available, including a TFXTREME® model.

TFXTREME® versions of the 3300 cables are offered for demanding applications in which a smooth feel at the control is essential. Teleflex 4300 and 6400 series cables — for heavy duty applications — are TFXTREME products.

How to Measure Control Cables

"Measure Twice. Order Once."

For a New Installation:

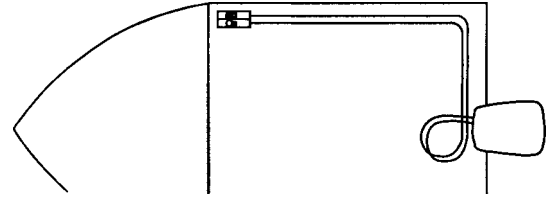

Outboards:

Measure from control along unobstructed cable routing to center of outboard. Add four feet to allow for loop which provides unrestricted engine movement. Round up to next whole foot and order required cable part number. (Last two digits of cable part number equal cable length in feet.)

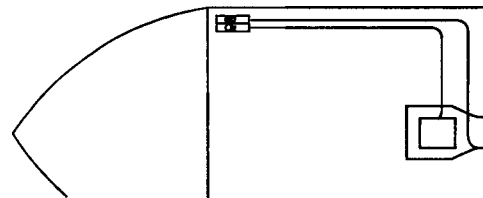

Inboards & Stern Drives:

Measure from control along unobstructed cable routing to shift and/or throttle connection. Round this dimension off to the next whole foot and order required cable part number. (Last two digits of cable part number equal cable length in feet.)



For Replacement of Existing Cable:

Remove old cable, measure from tip to tip and round up to the next whole foot.



TMAP

TELEFLEX MORSE
ASSEMBLERS'
PROGRAM



We are a TELEFLEX/MORSE factory TRAINED and LICENSED cable assembler. We use only top quality Teleflex/Morse components to build a wide range of replacement control cables. Now you don't have to wait weeks for that long or odd cable that no one has in stock. Call us first and we'll build your cable today!

PUSH-PULL CABLE IDENTIFICATION GUIDE

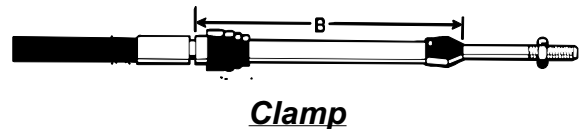
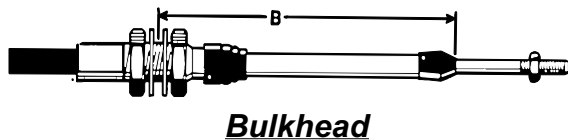

- Bulkhead
- Clamp
- Bulkhead/Clamp
- Throttle
- Clutch
- Utility
- Posi-lock
- Vernier

SERIES	ROD END THREAD SIZE	"B" DIMENSION		
		2" TRAVEL	3" TRAVEL	4" TRAVEL
30B	10-32	4"	5"	6"
30C		3 5/16"	4 5/16"	5 5/16"
40B	1/4-28	4 1/8"	5 1/8"	6 1/8"
40C		3 1/2"	4 1/2"	5 1/2"
60B	5/16-24	4 3/8"	5 3/8"	6 3/8"
60C		3 11/16"	4 11/16"	5 11/16"
80B	3/8-24	4 3/4"	5 3/4"	6 3/4"
80C		4 1/4"	5 1/4"	6 1/4"

NOTES: For "BC" type cables use a combination of the above dimensions.
To determine "B" dimension for 1" travel cables, subtract 1" from 2" travel figures above.
To determine "B" dimension for 5" travel cables, add 1" to 4" travel figures above.

30, 40, 60 & 80 Series Cables Built To Your Exact Length Requirements

Follow These 6 Easy
Steps To
Cable Identification

1. Check for part number on plastic jacket of cable.
2. Identify rod end thread size.
3. Determine type of hubs required: clamp, bulkhead, utility, etc.
4. Identify cable travel (see chart).
5. Measure cable length from rod end to rod end (tip to tip).
6. Call us at 1-800-225-0004 and we'll build your cable today!

Phone: 800-225-0004 ☎ Fax: 908-486-1056
e-mail: sales@sealandpower.com

Marine Utility cables

(panel-mount cables for remote control)

Utility Cable:

An easy-to-install, easy to operate flexible **push-pull cable** for remote control of choke, throttle, shut off, fuel valves, vents and many other applications.

- Available with either knob or T-handle.
- Solid stainless steel core wire resists corrosion, moves easily in HDPE liner.
- Black HDPE outer casing for durability and best resistance to UV and chemicals.
- Cables meet/exceed all applicable industry standards.



WITH KNOB:

- Utility Cable-Knob (5') 018872-000-0060
- Utility Cable-Knob (10') 018872-000-0120
- Utility Cable-Knob (15') 018872-000-0180
- Utility Cable-Knob (20') 018872-000-0240
- Utility Cable-Knob (25') 018872-000-0300
- Utility Cable-Knob (30') 018872-000-0360
- Utility Cable-Knob (35') 018872-000-0420
- Utility Cable-Knob (40') 018872-000-0480



WITH T-HANDLE:

- Utility Cable-T-handle (5') 018873-000-0060
- Utility Cable-T-handle (10') ... 018873-000-0120
- Utility Cable-T-handle (15') ... 018873-000-0180
- Utility Cable-T-handle (20') ... 018873-000-0240
- Utility Cable-T-handle (25') ... 018873-000-0300

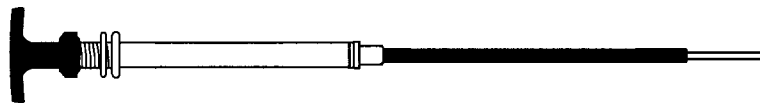

Positive Lock Cable:

Ideal when separate throttle control is required for engine warm-up or for operating auxiliary equipment. **A simple twist of the T-handle locks the cable in any setting.**

- Solid stainless steel core wire resists corrosion, moves easily in HDPE liner.
- Black HDPE outer casing for durability and best resistance to UV and chemicals.
- Cables meet/exceed all applicable industry standards.

- Positive Lock Cable (5') 043820-003-0060
- Positive Lock Cable (10') 043820-003-0120
- Positive Lock Cable (15') 043820-003-0180
- Positive Lock Cable (20') 043820-003-0240
- Positive Lock Cable (25') 043820-003-0300
- Positive Lock Cable (30') 043820-003-0360
- Positive Lock Cable (45') 043820-003-0540
- Positive Lock Cable (50') 043820-003-0600

Marine Utility cables

(panel-mount cables for remote control)

Vernier Cable:

Great for throttles or other applications where precise control is desired. **Push the button for fast easy setting of approximate position, then turn the knob for micro adjustment.**

- Positive, adjustable brake maintains settings regardless of vibration or governor back pressure.
- Black HDPE outer casing for durability and best resistance to UV and chemicals.
- Cables meet/exceed all applicable industry standards.

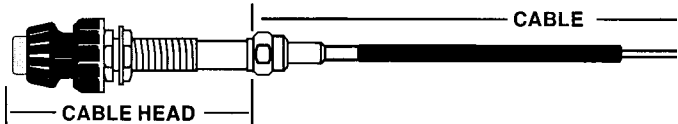

Vernier:

The vernier cable requires ordering 2 part numbers:

a Vernier Cable Head (which includes knob, button, panel body and fine adjustment mechanism)

PLUS

a Cable, which attaches to the Head.

Vernier Cable Head	307941-003
Vernier Cable (5')	307141-000-0060
Vernier Cable (10')	307141-000-0120
Vernier Cable (15')	307141-000-0180
Vernier Cable (20')	307141-000-0240
Vernier Cable (25')	307141-000-0300
Vernier Cable (30')	307141-000-0360
Vernier Cable (35')	307141-000-0420
Vernier Cable (40')	307141-000-0480

Conduit Fitting Kits:

Use these (formerly known as Hub Adapter Kits) to mount utility cables to mount in either bulkhead or clamp type applications.

BULKHEAD ADAPTER KIT



CLAMP ADAPTER KIT



Bulkhead Adapter Kit	300673
Clamp Adapter Kit	302485

DC Control:

Converts standard 3300 cable into a utility control. Install through a panel or mount nearly anywhere with optional bracket.

DC Control	301916
3300 type Cable	032377-003-XX

Mounting Bracket (stainless steel)048210





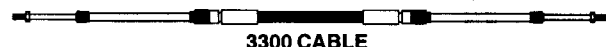

DC CONTROL

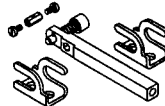
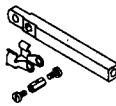
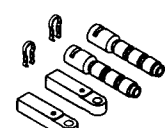
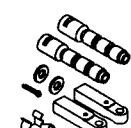
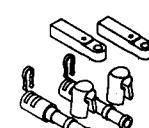
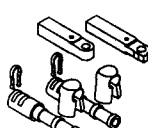

MOUNTING BRACKET

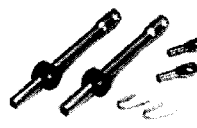

Control Cable Connection Kits, Fittings & Hardware

DESCRIPTION OF KIT	MORSE	TELEFLEX			
Engine-Specific Connection Kits for O.E.M. cables:					
For 1973-1978 OMC O.E.M. ("400" type) cables with bare wire ends:					
Evinrude/Johnson O/B Kit (35HP & less)	N/A	CA27208P			
Evinrude/Johnson O/B Kit (over 35HP)	N/A	CA27247P			
OMC Stern Drive Kit (all)	N/A	CA27247P			
<i>(NOTE: included clip is not used on stern drives.)</i>					
Engine-Specific Connection Kits for 3300 cables:					
Evinrude/Johnson O/B Kit (1979-date)	301729	CA27320P			
Evinrude/Johnson O/B Kit (pre-1979)	N/A	CA27321P			
Mercury Outboard Kit (1965-date)	301901	CA27319P			
Mercury Stern Drive Kit (all)	302123	CA27319P			
Mercury Inboard Kit (all)	N/A	CA27373P			
OMC Stern Drive Kit (all)	300557	CA27320P			
OEM Control-Specific Connection Kits for 3300 cables:					
Merc/Mariner Control Adapter - 3300 cable	301074	N/A			
OMC/J/E Control Adapter - 3300 cable	304939	N/A			
Universal Ball Joint Kits:					
Univ. 3300 Ball Joint (1/4-28) (1)	N/A	CA37701P			
Univ. 3300 Ball Joint (10-32) QR (1)	031799-001	N/A			
Univ. 3300 Ball Joint (1/4-28) QR (1)	031126	N/A			
Univ. 3300 Ball Joint (5/16-24) QR (1)	035242	N/A			
Univ. 4300 Ball Joint (1/4-28) (1)	N/A	CA28014P			
Univ. 4300 Ball Joint (1/4-28) QR (1)	029104	N/A			
Univ. 4300 Ball Joint (5/16-24) QR (1)	032267	N/A			
Univ. 6400 Ball Joint (5/16-24) (1)	N/A	CA28021P			
Univ. 6400 Ball Joint (5/16-24) QR (1)	029108	N/A			
Univ. 6400 Ball Joint (5/16-24) ST (1)	038491	N/A			
<i>(NOTE: QR type has external spring over ball receptor; ST does not.)</i>					

Control Cable Connection Kits, Fittings & Hardware

DESCRIPTION OF KIT	MORSE	TELEFLEX
--------------------	-------	----------

Universal Clevis Kits:

Univ. 3300 Clevis (10-32, 1/4" pin) (1)	N/A	CA37700P
Univ. 3300 Clevis (10-32, 3/16" pin) (1)	031800	N/A
Univ. 3300 Clevis (10-32, 1/4" pin) (1)	031125	N/A
Univ. 3300 Clevis (10-32, 5/16" pin) (1)	033395	N/A
Univ. 4300 Clevis (1/4-28, 1/4" pin) (1)	N/A	CA28022P
Univ. 4300 Clevis (1/4-28, 1/4" pin) (1)	029025	N/A
Univ. 4300 Clevis (1/4-28, 5/16" pin) (1)	042212	N/A
Univ. 4300 Clevis (1/4-28, 5/8" pin) (1)	045985	N/A
Univ. 6400 Clevis (5/16-24, 5/16" pin) (1)	N/A	CA28023P
Univ. 6400 Clevis (1/4-28, 5/16" pin) (1)	029132-001	N/A
Univ. 6400 Clevis (1/4-28, 5/8" pin) (1)	042034	N/A

3300 SERIES
CA37700P
031880
031125
033395

4300 SERIES
CA28022
029025
042212
045985

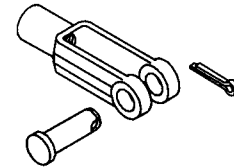

6400 SERIES
CA28023P
029132-001
042034

Pivots 3300 Series

	A	B	C	D	E	MORSE	TELEFLEX
in	3/16	7/16	3/8	9/64	11/16	045583	N/A
mm	4.8	11.1	9.5	3.6	17.5		
in	1/4	7/16	21/64	9/64	5/8	031029	N/A
mm	6.4	11.1	8.3	3.6	15.9		
in	1/4	7/16	3/8	.191	23.32	031539	N/A
mm	6.4	11.1	9.5	4.9	18.3		
in	1/4	7/16	21/64	.295	25/32	032392	N/A
mm	6.4	11.1	8.3	7.5	19.8		
in	1/4	7/16	3/8	.316	15/16	039890	N/A
mm	6.4	11.1	9.5	8.0	23.8		
in	1/4	1/2	3/8	.376	15/16	043939	N/A
mm	6.4	12.7	9.5	9.6	23.8		
in	5/16	7/16	3/8	13/32	1-1/16	037691	N/A
mm	7.9	11.1	9.5	10.3	27.0		
in	5/16	7/16	3/8	7/16	1	039471	N/A

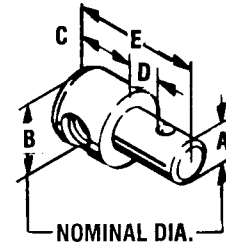

3300 SERIES
045583
031029
031539
032392
039890
043939
037691
039471

4300 SERIES
039110
031537
036631
045199
042419

Pivots 4300 Series

in	1/4	1/2	7/16	9/64	3/4	039110	N/A
mm	6.4	12.7	11.1	3.6	19.1		
in	1/4	1/2	1/2	13/64	7/8	031537	N/A
mm	6.4	12.7	12.7	5.2	22.2		
in	1/4	1/2	1/2	17/64	15/16	036361	N/A
mm	6.4	12.7	12.7	6.7	23.8		
in	5/16	1/2	9/16	9/64	29/32	045199	N/A
mm	7.9	12.7	14.3	3.6	23.0		
in	3/8	9/16	1/2	25/64	13/16	042419	N/A
mm	9.5	14.3	12.7	9.9	20.6		

Control Cable Connection Kits, Fittings & Hardware

DESCRIPTION OF KIT	MORSE	TELEFLEX
Other Universal Cable Connection Kits, continued:		
Eye Terminal – 3300 (10-32, 5/16" pin) (1)	031980	N/A
Eye Terminal – 3300 (10-32, 5/16" pin) (1)	300646	N/A
Eye Terminal – 4300 (1/4-28, 5/16" pin) (1)	041134	N/A
Eye Terminal – 6400 (5/16-24, 5/16" pin) (1)	045428	N/A
Eye Terminal – 6400 (5/16-24, 1/2" pin) (1)	041316	N/A
Pin for Eye Terminal (1.5", 5/16" dia.)	300965	N/A
Pin for Eye Terminal (1.687", 5/16" dia.)	047383	N/A
Terminal Pin Kit (300965, ring, nut, washer)	301456	N/A
Spring Link Terminal – 3300 Cables	031545	N/A
Univ. 3300 Clamp & Shim Kit (1)	N/A	CA28020P
Univ. 3300 Clamp (1)	032010	N/A
3300 Clamp (for bare conduit) (1)	037664	N/A
3300 Clamp (for bare cond. or ftg.) (1)	031509	N/A
3300 Clamp Shim for 032010 (1)	035777	N/A
Univ. 4300 Clamp & Shim Kit (1)	N/A	CA28018P
Univ. 4300 Clamp – 2 Holes (1)	031532	N/A
Heavy Duty 4300 Clamp – 4 Holes (1)	021227	N/A
4300 Clamp Shim for 031532 & 021227 (1)	031538	N/A
<i>(NOTE: 2 shims required for each 021227 clamp.)</i>		
Univ. 6400 Clamp & Shim Kit (1)	N/A	CA28019P
Heavy Duty 6400 Clamp – 4 Holes (1)	036733	N/A
6400 Clamp Shim (1)	031538	N/A
Univ. 3300 Inboard Connection Kit (2)	N/A	CA27024P
<i>(Above contains: (2) CA37701P Ball Joints & (2) CA35074P Brackets.)</i>		
Univ. 3300 Inboard Connection Bracket	N/A	CA35074P
Univ. 3300 Inboard Connection Bracket (1)	036174	N/A
<i>(Old Morse description: "Cable Hook Clip – Single")</i>		
Univ. 3300 Inboard Connection Bracket (1)	031419	N/A
<i>(Old Morse description: "Cable Clip – 30 Series Only")</i>		
Univ. 3300 Parallel Connection Kit (2)	N/A	CA27328P
Univ. 3300 Parallel Connection Kit (2)	035531	N/A
<i>(Old Morse description: "Cable Hook Clip – Dual")</i>		
Other Cable Kits/Accessories:		
Anti-Vibration Cable Mount – 3300	294200	N/A
Anti-Vibration Cable Mount – 4300	294201	N/A
Stop Collar – 3300	037693	N/A
Cable Brake – 3300, 4300 & 6400 Cables	044386	N/A

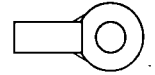

EYE TERMINAL

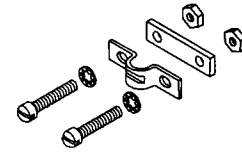

3300 SERIES	4300 SERIES	6400 SERIES
CA28020P	CA28018P	CA28019P
032010	031532	036733
037664	021227	031538
031509	031538	
035777		

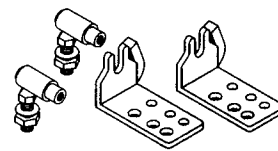

CA27024P

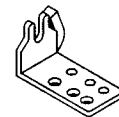

CA35074P
036174
031419

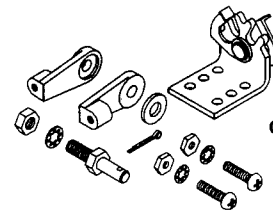

CA27328P

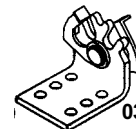

035531

Control Cable Connection Kits, Fittings & Hardware

DESCRIPTION OF KIT	MORSE	TELEFLEX
--------------------	-------	----------

Conduit Fitting [Hub] Adapter Kits

Bulkhead Adapter Kit	300673	N/A
Clamp Adapter Kit	302485	N/A



These kits are used in the field to adapt utility, neutral throttle, and vernier cables to mount in bulkhead or clamp applications.

Pre-Engineered Clutch Kits

For Dual Station 33C Cables:

Borg-Warner (70, 71 & 72 inline-red gear)	301474	N/A
Twin Disc (MG, 508, 509, 510, 510A, 512)	042577	N/A
Twin Disc (514C, 514CHP, 518, 521, 527)	042577	N/A
Twin Disc (530 & 540)	042577	N/A
Twin Disc (MG502, 506 & 507)	063696 (right)	N/A

To Convert to 43C Cables Add:

300665
300665
300665
300665
300665

All-Purpose Clutch & Throttle Kits-Dual Station

Connection Kit - 3300 Cable	036680*	N/A
Connection Kit - 4300 Cable	040773 *	N/A

**These kits include the cable end fittings, clamps, and hardware needed to assemble a clutch or throttle kit. They do not include the main mounting bracket. This must be fabricated locally.*

036680

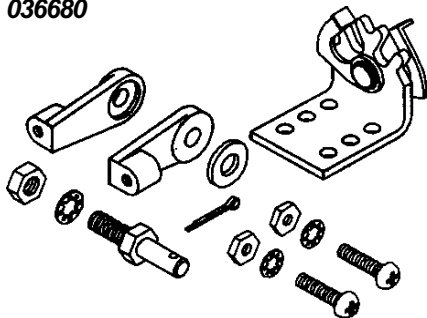

040773

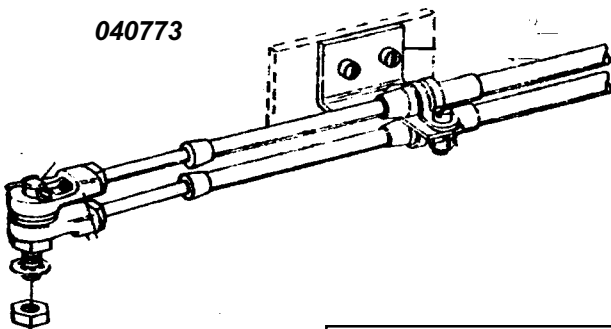

063696

