

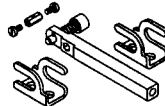

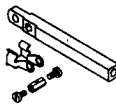

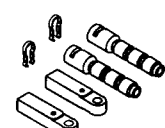

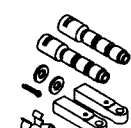
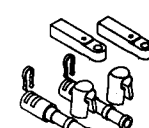
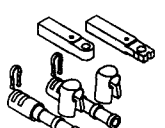

Control Cable Connection Kits, Fittings & Hardware

DESCRIPTION OF KIT	MORSE	TELEFLEX			
Engine-Specific Connection Kits for O.E.M. cables:					
For 1973-1978 OMC O.E.M. ("400" type) cables with bare wire ends:					
Evinrude/Johnson O/B Kit (35HP & less)	N/A	CA27208P			
Evinrude/Johnson O/B Kit (over 35HP)	N/A	CA27247P			
OMC Stern Drive Kit (all)	N/A	CA27247P			
<i>(NOTE: included clip is not used on stern drives.)</i>					
Engine-Specific Connection Kits for 3300 cables:					
Evinrude/Johnson O/B Kit (1979-date)	301729	CA27320P			
Evinrude/Johnson O/B Kit (pre-1979)	N/A	CA27321P			
Mercury Outboard Kit (1965-date)	301901	CA27319P			
Mercury Stern Drive Kit (all)	302123	CA27319P			
Mercury Inboard Kit (all)	N/A	CA27373P			
OMC Stern Drive Kit (all)	300557	CA27320P			
OEM Control-Specific Connection Kits for 3300 cables:					
Merc/Mariner Control Adapter - 3300 cable	301074	N/A			
OMC/J/E Control Adapter - 3300 cable	304939	N/A			
Universal Ball Joint Kits:					
Univ. 3300 Ball Joint (1/4-28) (1)	N/A	CA37701P			
Univ. 3300 Ball Joint (10-32) QR (1)	031799-001	N/A			
Univ. 3300 Ball Joint (1/4-28) QR (1)	031126	N/A			
Univ. 3300 Ball Joint (5/16-24) QR (1)	035242	N/A			
Univ. 4300 Ball Joint (1/4-28) (1)	N/A	CA28014P			
Univ. 4300 Ball Joint (1/4-28) QR (1)	029104	N/A			
Univ. 4300 Ball Joint (5/16-24) QR (1)	032267	N/A			
Univ. 6400 Ball Joint (5/16-24) (1)	N/A	CA28021P			
Univ. 6400 Ball Joint (5/16-24) QR (1)	029108	N/A			
Univ. 6400 Ball Joint (5/16-24) ST (1)	038491	N/A			
<i>(NOTE: QR type has external spring over ball receptor; ST does not.)</i>					
					
					
					
			3300 SERIES	4300 SERIES	6400 SERIES
			CA37701P	CA28014P	CA28021
			031799-001	029104	029108
			031126	032267	038491
			035242		

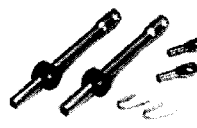
Control Cable Connection Kits, Fittings & Hardware

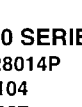
DESCRIPTION OF KIT	MORSE	TELEFLEX
--------------------	-------	----------

Universal Clevis Kits:

Univ. 3300 Clevis (10-32, 1/4" pin) (1)	N/A	CA37700P
Univ. 3300 Clevis (10-32, 3/16" pin) (1)	031800	N/A
Univ. 3300 Clevis (10-32, 1/4" pin) (1)	031125	N/A
Univ. 3300 Clevis (10-32, 5/16" pin) (1)	033395	N/A
Univ. 4300 Clevis (1/4-28, 1/4" pin) (1)	N/A	CA28022P
Univ. 4300 Clevis (1/4-28, 1/4" pin) (1)	029025	N/A
Univ. 4300 Clevis (1/4-28, 5/16" pin) (1)	042212	N/A
Univ. 4300 Clevis (1/4-28, 5/8" pin) (1)	045985	N/A
Univ. 6400 Clevis (5/16-24, 5/16" pin) (1)	N/A	CA28023P
Univ. 6400 Clevis (1/4-28, 5/16" pin) (1)	029132-001	N/A
Univ. 6400 Clevis (1/4-28, 5/8" pin) (1)	042034	N/A

3300 SERIES
CA37700P
031880
031125
033395

4300 SERIES
CA28022
029025
042212
045985

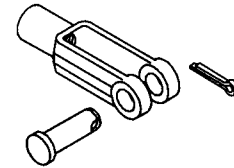

6400 SERIES
CA28023P
029132-001
042034

Pivots 3300 Series

	A	B	C	D	E	MORSE	TELEFLEX
in	3/16	7/16	3/8	9/64	11/16	045583	N/A
mm	4.8	11.1	9.5	3.6	17.5		
in	1/4	7/16	21/64	9/64	5/8	031029	N/A
mm	6.4	11.1	8.3	3.6	15.9		
in	1/4	7/16	3/8	.191	23.32	031539	N/A
mm	6.4	11.1	9.5	4.9	18.3		
in	1/4	7/16	21/64	.295	25/32	032392	N/A
mm	6.4	11.1	8.3	7.5	19.8		
in	1/4	7/16	3/8	.316	15/16	039890	N/A
mm	6.4	11.1	9.5	8.0	23.8		
in	1/4	1/2	3/8	.376	15/16	043939	N/A
mm	6.4	12.7	9.5	9.6	23.8		
in	5/16	7/16	3/8	13/32	1-1/16	037691	N/A
mm	7.9	11.1	9.5	10.3	27.0		
in	5/16	7/16	3/8	7/16	1	039471	N/A

Pivots 4300 Series

in	1/4	1/2	7/16	9/64	3/4	039110	N/A
mm	6.4	12.7	11.1	3.6	19.1		
in	1/4	1/2	1/2	13/64	7/8	031537	N/A
mm	6.4	12.7	12.7	5.2	22.2		
in	1/4	1/2	1/2	17/64	15/16	036361	N/A
mm	6.4	12.7	12.7	6.7	23.8		
in	5/16	1/2	9/16	9/64	29/32	045199	N/A
mm	7.9	12.7	14.3	3.6	23.0		
in	3/8	9/16	1/2	25/64	13/16	042419	N/A
mm	9.5	14.3	12.7	9.9	20.6		

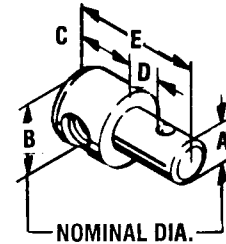

3300 SERIES
045583
031029
031539
032392
039890
043939
037691
039471

4300 SERIES
039110
031537
036631
045199
042419

Control Cable Connection Kits, Fittings & Hardware

DESCRIPTION OF KIT	MORSE	TELEFLEX
Other Universal Cable Connection Kits, continued:		
Eye Terminal – 3300 (10-32, 5/16" pin) (1)	031980	N/A
Eye Terminal – 3300 (10-32, 5/16" pin) (1)	300646	N/A
Eye Terminal – 4300 (1/4-28, 5/16" pin) (1)	041134	N/A
Eye Terminal – 6400 (5/16-24, 5/16" pin) (1)	045428	N/A
Eye Terminal – 6400 (5/16-24, 1/2" pin) (1)	041316	N/A
Pin for Eye Terminal (1.5", 5/16" dia.)	300965	N/A
Pin for Eye Terminal (1.687", 5/16" dia.)	047383	N/A
Terminal Pin Kit (300965, ring, nut, washer)	301456	N/A
Spring Link Terminal – 3300 Cables	031545	N/A
Univ. 3300 Clamp & Shim Kit (1)	N/A	CA28020P
Univ. 3300 Clamp (1)	032010	N/A
3300 Clamp (for bare conduit) (1)	037664	N/A
3300 Clamp (for bare cond. or ftg.) (1)	031509	N/A
3300 Clamp Shim for 032010 (1)	035777	N/A
Univ. 4300 Clamp & Shim Kit (1)	N/A	CA28018P
Univ. 4300 Clamp – 2 Holes (1)	031532	N/A
Heavy Duty 4300 Clamp – 4 Holes (1)	021227	N/A
4300 Clamp Shim for 031532 & 021227 (1)	031538	N/A
<i>(NOTE: 2 shims required for each 021227 clamp.)</i>		
Univ. 6400 Clamp & Shim Kit (1)	N/A	CA28019P
Heavy Duty 6400 Clamp – 4 Holes (1)	036733	N/A
6400 Clamp Shim (1)	031538	N/A
Univ. 3300 Inboard Connection Kit (2)	N/A	CA27024P
<i>(Above contains: (2) CA37701P Ball Joints & (2) CA35074P Brackets.)</i>		
Univ. 3300 Inboard Connection Bracket	N/A	CA35074P
Univ. 3300 Inboard Connection Bracket (1)	036174	N/A
<i>(Old Morse description: "Cable Hook Clip – Single")</i>		
Univ. 3300 Inboard Connection Bracket (1)	031419	N/A
<i>(Old Morse description: "Cable Clip – 30 Series Only")</i>		
Univ. 3300 Parallel Connection Kit (2)	N/A	CA27328P
Univ. 3300 Parallel Connection Kit (2)	035531	N/A
<i>(Old Morse description: "Cable Hook Clip – Dual")</i>		
Other Cable Kits/Accessories:		
Anti-Vibration Cable Mount – 3300	294200	N/A
Anti-Vibration Cable Mount – 4300	294201	N/A
Stop Collar – 3300	037693	N/A
Cable Brake – 3300, 4300 & 6400 Cables	044386	N/A

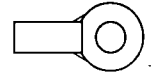

EYE TERMINAL

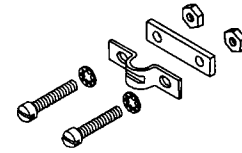

3300 SERIES	4300 SERIES	6400 SERIES
CA28020P	CA28018P	CA28019P
032010	031532	036733
037664	021227	031538
031509	031538	
035777		

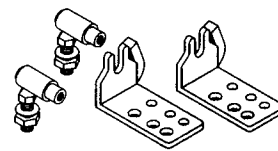

CA27024P

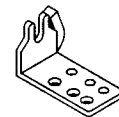

CA35074P
036174
031419

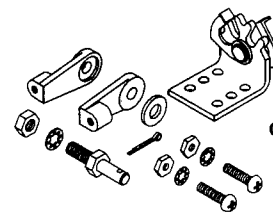

CA27328P

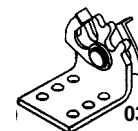

035531

Control Cable Connection Kits, Fittings & Hardware

DESCRIPTION OF KIT	MORSE	TELEFLEX
--------------------	-------	----------

Conduit Fitting [Hub] Adapter Kits

Bulkhead Adapter Kit	300673	N/A
Clamp Adapter Kit	302485	N/A



These kits are used in the field to adapt utility, neutral throttle, and vernier cables to mount in bulkhead or clamp applications.

Pre-Engineered Clutch Kits

For Dual Station 33C Cables:

Borg-Warner (70, 71 & 72 inline-red gear)	301474	N/A
Twin Disc (MG, 508, 509, 510, 510A, 512)	042577	N/A
Twin Disc (514C, 514CHP, 518, 521, 527)	042577	N/A
Twin Disc (530 & 540)	042577	N/A
Twin Disc (MG502, 506 & 507)	063696 (right)	N/A

To Convert to 43C Cables Add:

300665
300665
300665
300665
300665

All-Purpose Clutch & Throttle Kits-Dual Station

Connection Kit - 3300 Cable	036680*	N/A
Connection Kit - 4300 Cable	040773 *	N/A

**These kits include the cable end fittings, clamps, and hardware needed to assemble a clutch or throttle kit. They do not include the main mounting bracket. This must be fabricated locally.*

036680

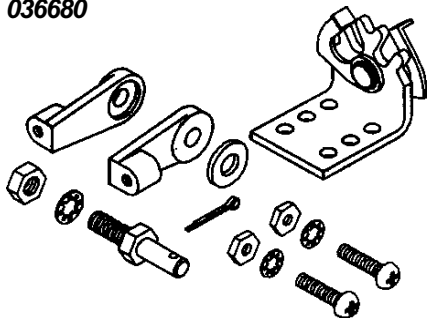

040773

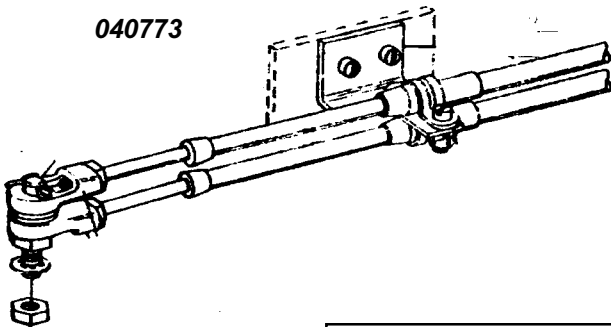

063696

