

Morse Command 290

Morse®

Morse Controls mechanical steering systems are no longer being produced. Many items, such as the Command 290 components shown here, are still available. Contact us when replacing Morse steering components for current availability or a recommendation for an upgrade to a new Teleflex steering system.

**MORSE COMMAND 290
SINGLE CABLE
ROTARY SYSTEM**



**MORSE COMMAND 290
TWIN CABLE
ROTARY SYSTEM**



(3 turns lock-to-lock)

Components:

- Command 290 helm (no brake)292525
- Command 290 twin cable helm (with brake)305015
- 90° Black Bezel (replaces 292521)308559
- Command 290 Rotary Steering Cable (replaces 304411-000-XXX) **SSC61XX**

292525/
304857

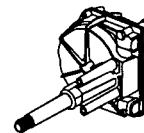
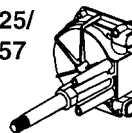

305015



308559
(replaces
292521)



SSC61XX
(replaces 304411-000-XXX)

Options:

- Command 290 helm (with brake)304857
- 20° Black Bezel (replaces 293090)308561
- Adjustable Brake (Friction Device)292522

Service Items:

- Command 290 Helm Cable Take-up Tube (Spent Travel Tube)301098
- Command 290 Helm Hardware Kit.....305002

Big-T[®] inboard steering

The Original Teleflex Steering System!
For over 35 years, Big-T[®] has been the most durable, versatile mechanical steering system made, with both single and dual station capability. The heavy duty helm incorporates a strong steel pinion, dual diecast gears and meaty shaft bearing supports, all encased in a rugged gear housing. It's no wonder owners of small inboards have counted on the Teleflex Big-T since 1963!

**BIG-T[®]
SINGLE STATION SYSTEM**

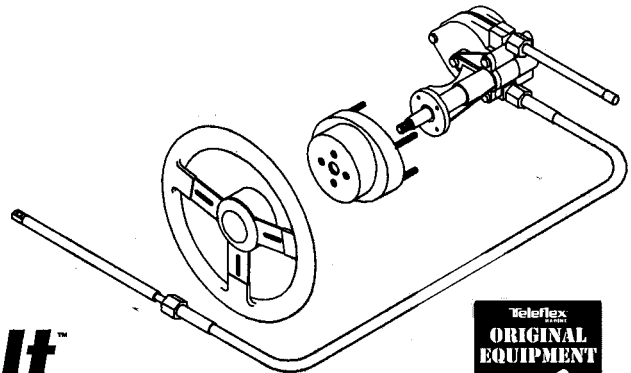

Tilt
STEERING
available!

Features:

- Available in single or dual station versions.
- Responsive 3 turns from lock-to-lock.†
- Standard 3/4" tapered steering shaft.
- Stainless steel cable output ends.
- 2-piece bezel for 90° or 20° helm mount to dash.
- Optional 1-piece 90° bezel for compact mounting.
- Uses Teleflex SSC72 type cable.‡
- Meets A.B.Y.C. standards.
- Meets N.M.M.A. certification requirements.

† 3.0 turns when all of standard steering cable travel is utilized.

‡ Tension and dual station require purchase of different cables.

(3 turns lock-to-lock)

**BIG-T[®]
DUAL STATION SYSTEM**

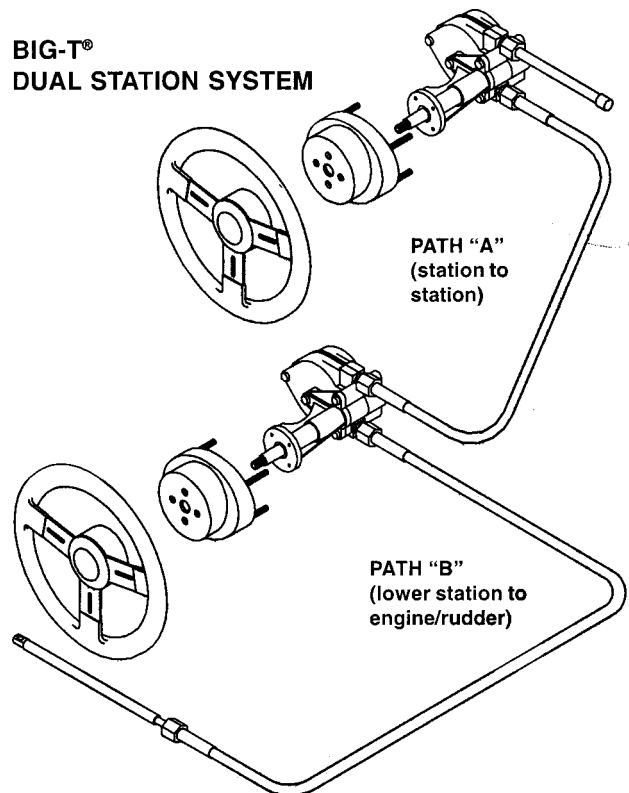

Applications:

Inboards to 34 feet with one or two engines. Also suitable for stern drive boats with power-assisted steering.

****Replaces most MORSE CONTROLS rotary steering systems.**

Big-T[®] inboard steering

Components:

- Big-T Helm.....SH5000P
- Big-T Cable (single station push-pull)SSC72XX
(XX = cable length in feet. A 14' SSC72 would be SSC7214.)
- QC II Cable (single station push-pull)SSC61XX
- Big-T Cable (dual station)..... SSC81AxxBxx
(This is a special-order cable and is not returnable; xx = length in feet.)
- Bezel 2-pc. Black (90°/20° mount) .. SB27265P

Options:

- Big-T Tilt Helm SH91525P*
- * Requires SH91500/SH91700 tilt mechanism to complete Tilt Steering system installation.
- Performance Tilt Mechanism SH91500P
- TFXtreme Tilt Mechanism SH91700P
- Bezel 2-pc. White (90°/20° mount).. SB27263P
- Bezel 1-pc. Chrome (90° mount)..... SB27268P
- Cable Gard (fits most tilt tubes) SA39329P

Service Items:

- Steering Wheel Hardware Kit 2745417P
- Spent Travel Tube (Big-T) SA35680P
- Dual Station Conduit (Path "A") SC70XX
- Dual Station Cable (Path "B") SSC40XX

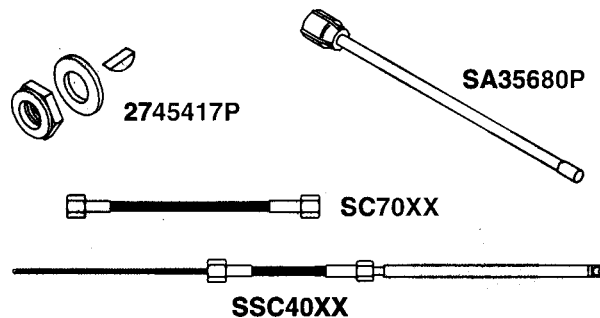
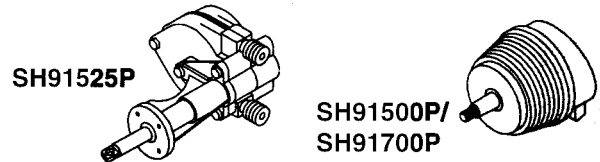
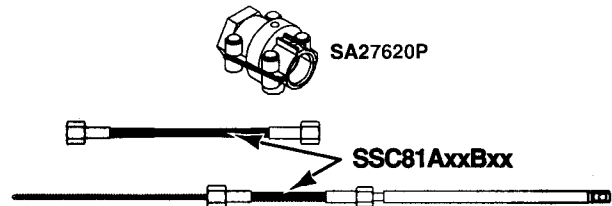
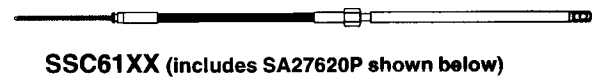
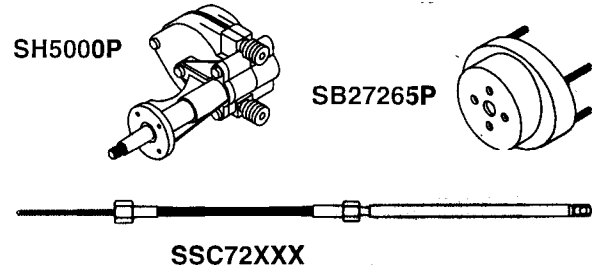

How To Measure Cable for Dual Station Big-T:

PATH "A": CENTER LINE OF WHEEL TO CENTER LINE OF WHEEL.

PATH "B": CENTER LINE OF WHEEL TO CABLE CONNECTION AT CENTERED TILLER.

(See also the Technical Reference Section.)

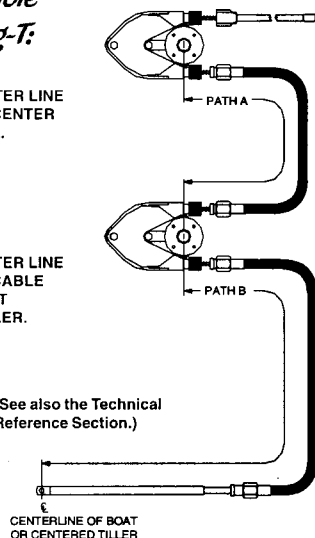

(For example, if the cable routing from engine to lower station is 18 feet and 10 feet from station to station, order part number SSC81A10B18 cable.)

Phone: 800-225-0004 Fax: 908-486-1056
e-mail: sales@sealandpower.com

NFB™ 4.2 outboard steering

Patented No FeedBack Steering Control for about the cost of an old-fashioned steering replacement. With the advantage of 4.2 turns lock-to-lock and our patented No FeedBack steering to lock out steering loads, Teleflex's 4.2 Rotary NFB Steering Systems are the most revolutionary advance in mechanical steering in many years. Available with a single cable configuration for most boats and dual cable for applications with engine flutter or steering instability.



Features:

- Patented No FeedBack™ Steering mechanism.
- Comfortable 4.2 turns from lock-to-lock.
- Minimal clutch free play.
- Standard 3/4" tapered steering shaft.
- Stainless steel cable output ends.
- Fast, easy installation: uses Teleflex Quick Connect (QC) steering cable and industry-standard Safe-T mounting hardware.
- Meets A.B.Y.C. standards.
- Meets N.M.M.A. certification requirements.

Applications:

Virtually all of today's outboard boats with wheels to 16" diameter.

Single cable configuration for most boats. Dual cable for boats with engine flutter or steering instability.

Replaces Teleflex Safe-T® steering systems without dash modification.

For single station use only.

****Replaces most MORSE CONTROLS and older TELEFLEX rotary steering systems for non-power-assist outboards & I/Os.**

NFB™ 4.2
SINGLE CABLE SYSTEM

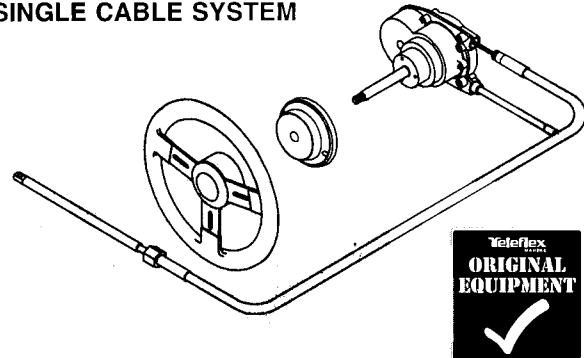

NFB™ 4.2
DUAL CABLE SYSTEM

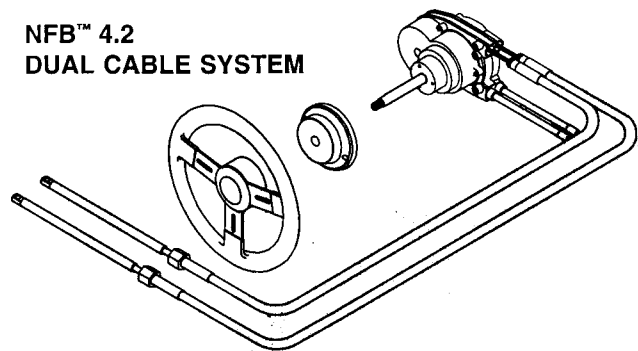

(4.2 turns lock-to-lock)

Tilt
STEERING
available!

Phone: 800-225-0004 ☎ Fax: 908-486-1056
e-mail: sales@sealandpower.com

NFB™ 4.2 outboard steering

Complete Systems:

- NFB 4.2 Tilt Steering Kit
(Single Cable) SS157XX
- NFB 4.2 Steering Kit
(Single Cable) SS147XX
- NFB 4.2 Dual Steering Kit
(Dual Cable) SS148XX



Components:

- NFB 4.2 Helm SH4910P
- NFB 4.2 Dual Helm SH4920P
- QC Cable SSC62XX
(XX = cable length in feet. A 14' SSC62 would be SSC6214.)
- Rotary NFB Bezel (90°) SB27150P

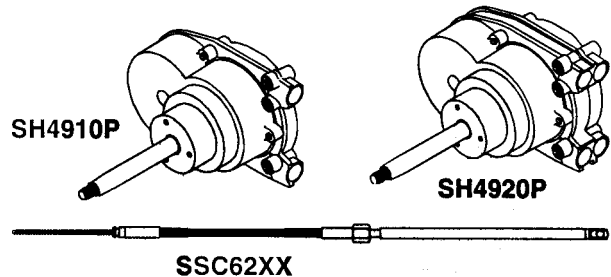

Options:

- NFB 4.2 Single Tilt Dash Module .. SH1534910
Includes tilt helm and mechanism. Easy way to upgrade to Tilt or replace older Tilt systems. Requires SSC61 or SSC62 cable.
- NFB 4.2 Single Tilt Helm SH91526P*
- NFB 4.2 Dual Tilt Helm SH91527P*
- * Requires SH91500/SH91700 tilt mechanism to complete Tilt Steering system installation.*
- Performance Tilt Mechanism SH91500P
- TFXtreme Tilt Mechanism SH91700P
- Bezel (20°) SB27483P
- Universal Tie Bar SA27252P
(NOTE: Maximum tie bar length: 25-1/2")
- Cable Gard (fits most tilt tubes) SA39329P

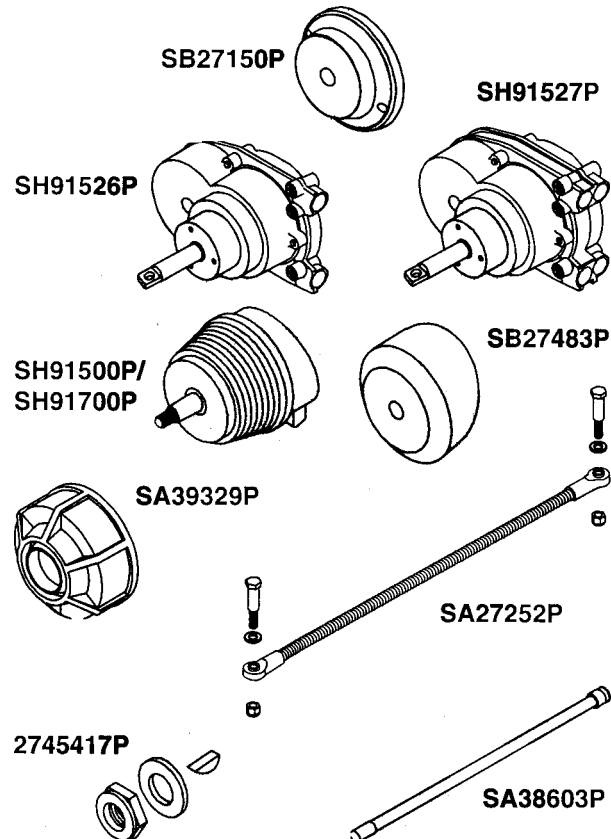

Service Items:

- Steering Wheel Hardware Kit 2745417P
- Spent Travel Tube (Rotary NFB) SA38603P

Phone: 800-225-0004 Fax: 908-486-1056
e-mail: sales@sealandpower.com

Safe-T[®] QC sterndrive steering

Traditional Teleflex Marine mechanical steering is still the choice for stern drives, inboards and other power assisted applications. It's just right for power steered boats in which No FeedBack™ systems are not required. Safe-T[®] QC offers the quick response of three-turn steering, and easy installation with a patented, no-tools-required cable connection at the helm. In single cable configurations, this is a great 3-turn choice for power-steered boats.

Features:

- Quick-response of 3 turns lock-to-lock.
- Kits include: cable, helm, bezel and hardware.
- Standard 3/4" tapered steering shaft.
- Stainless steel cable output ends.
- Fast, easy installation: uses simple snap-in cable connection, Teleflex Quick Connect (QC) cable, and industry-standard Safe-T mounting hardware.
- Meets A.B.Y.C. standards.
- Meets N.M.M.A. certification requirements.

Applications:

Virtually all power-assisted stern drive boats with wheels up to 16" diameter. Safe-T QC™ replaces all Teleflex Safe-T helms made since 1968 with little or no dash modifications. (Requires use of SSC62 QC steering cable.)

For single station use only.

**** Replaces most MORSE CONTROLS and older TELEFLEX rotary steering systems for power-assist outboards, I/Os and small inboards.**

Teleflex[®]
MARINE

SAFE-T QC[®]
SINGLE CABLE SYSTEM

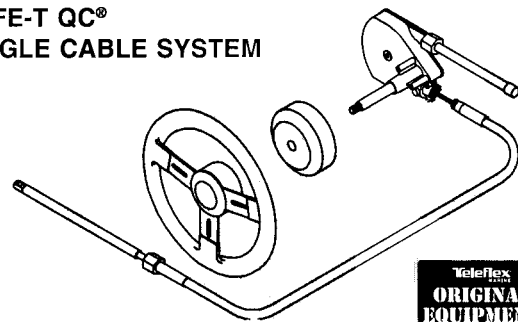

SAFE-T QC[®]
TWIN CABLE SYSTEM

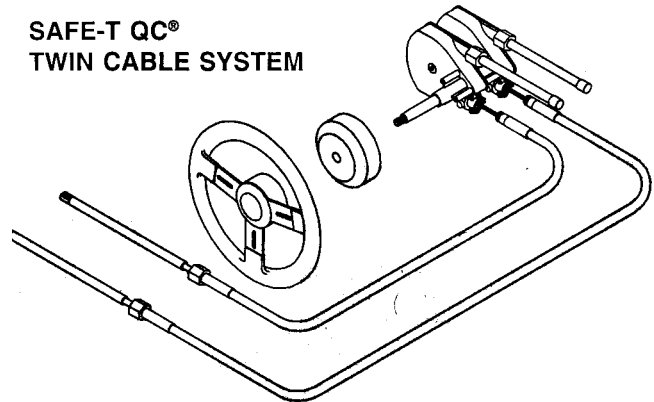

(3 turns lock-to-lock)

Tilt
STEERING
available!

Phone: 800-225-0004 ☎ Fax: 908-486-1056
e-mail: sales@sealandpower.com

Safe-T[®] QC sterndrive steering

Complete System:

Safe-T QC Steering Kit (single cable) SS137XX

Components:

Safe-T QC Single Helm SH5094P

QC Cable SSC62XX
(XX = cable length in feet. A 14' SSC62 would be SSC6214.)

Safe-T QC Bezel (90°) SB27484P

Options:

Safe-T QC Sgl. Tilt Dash Module .. SH1535094
Includes tilt helm and mechanism. Easy way to upgrade to Tilt or replace older Tilt systems. Requires SSC61 or SSC62 cable.

Safe-T QC Single Tilt Helm SH91523P*
** Requires SH91500/SH91700 tilt mechanism to complete Tilt Steering system installation.*

Safe-T QC Dual Tilt Helm SH91524P*†
** Requires SH91500/SH91700 tilt mechanism to complete Tilt Steering system installation.
† For dual cable steered stern drives.*

Performance Tilt Mechanism SH91500P
TFXtreme Tilt Mechanism SH91700P

Safe-T QC Dual Helm SH5294P†

Safe-T QC Bezel (20°) SB27483P
Cable Gard (fits most tilt tubes) SA39329P

Service Items:

Safe-T "TS" helm SH5023P

Safe-T Cable (with helm nut) SSC72XX
QC II Cable (Safe-T QC or "TS") SSC61XX
QCII Threaded Helm Converter SA27620P

Steering Wheel Hardware Kit 2745417P
Spent Travel Tube SA35680P

