

SHERWOOD

Seawater Strainer and Bracket

- Full Flow Filtering with Ultra Low Pressure Differential
- Easy In-Line Cleaning
- Durable Non-Corrosive Construction
- Quick Clear Bowl Examination
- Lightweight with Optional Mounting Bracket
- Stainless Steel Screens



Strainer Description

Strainer Number	Port Size	Screen Mesh	Bracket No.
15935	1/2"	20 Mesh	N/A
18004	1/2"	50 Mesh	N/A
18001	3/4"	20 Mesh	14240
18005	1"	20 Mesh	14239
18016	1-1/4"	20 Mesh	14238
18029	1-1/2"	20 Mesh	21930

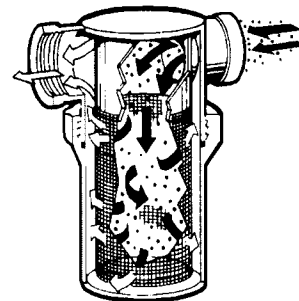

Strainer Components

Strainer Number	Screen No.	O-ring No.	Bowl No.
15935	11810	11805	14379
18004	11811	11805	14379
18001	11810	11805	14379
18005	11807	11803	14380
18016	14214	11803	14380
18029	16126	11803	14380



Engine Cooling Pumps

- Heavy Duty Design for Pulley Drive or Long Couple
- Mechanical Seal for Extended Seal Life
- Rear Support Bushing for Load Absorption
- Ball Bearing Supported Drive Shaft
- Corrosion Resistant Bronze Constructed
- Neoprene Impeller and Buna Seal - Standard
- Stainless Steel Shaft

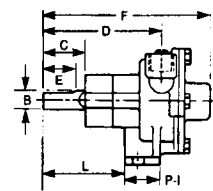
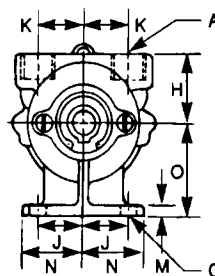

Model No.	Impeller	Port Size	Dimensions (Inches)														
			B	C	D	E	F	G	H	I	J	K	L	M	N	O	P
R30G	10077	1/2" NPT	.50	1.50	3.56	1.0	5.28	.34	1.47	.75	1.06	1.12	3.09	.25	1.44	1.38	.44
R50G	09959	3/4" NPT	.63	1.50	4.06	1.0	5.28	.41	1.63	.75	1.12	1.25	3.34	.25	1.50	2.12	.50
R102	10615	1" NPT	.63	1.50	4.53	1.0	6.66	.41	2.12	.88	1.38	1.50	3.97	.25	1.81	2.12	.56

• Recommended Horsepower: R30G - 1/2, R50G - 3/4, R102 - 2.

Phone: 800-225-0004 Fax: 908-486-1056
e-mail: sales@sealandpower.com

SHERWOOD

G Series Flexible Impeller Pumps

- Mechanical Seal
- Bronze Housing
- Stainless Steel Shaft
- Sealed Ball Bearing
- Excellent for Engine Cooling, Either as Replacement for Obsolete Pump or New Installation



Horizontal Porting G1 & G3



Vertical Porting G2, G4, & G11

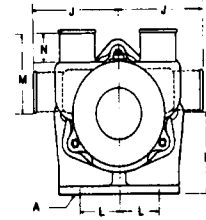
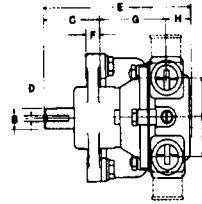
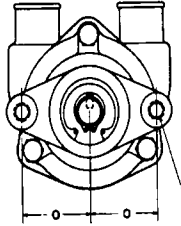

Model No.	Impeller	Port Size	Dimensions (Inches)															
			A	B	C	D	E	F	G	H	I	J	K	L	M	N	O	P
G1	09959	1" Hose	13/32	5/8	2-1/64	3/16	5-1/4	1/2	2-25/64	27/32	1-1/4	2-5/8	2-1/8	1-3/8	-	7/8	1-5/8	3/8
G2	09959	1" Hose	13/32	5/8	2-1/64	3/16	5-1/4	1/2	2-25/64	27/32	1-1/4	-	2-1/8	1-3/8	2-1/4	7/8	1-5/8	3/8
G3	10615	1-1/4" Hose	13/32	5/8	2-1/64	3/16	5-5/8	1/2	2-37/64	1-1/32	1-1/2	2-5/8	2-1/8	1-3/8	-	7/8	1-5/8	3/8
G4	10615	1-1/4" Hose	13/32	5/8	2-1/64	3/16	5-5/8	1/2	2-37/64	1-1/32	1-1/2	-	2-1/8	1-3/8	2-5/16	7/8	1-5/8	3/8
G8	10615	1-1/4" Hose	13/32	5/8	2-1/64	3/16	-	1/2	-	-	1-1/2	-	2-1/8	1-3/8	-	7/8	1-5/8	3/8
G11	09000	1/2" NPT	13/32	5/8	2-1/64	3/16	5-1/4	1/2	2-25/64	27/32	1-1/4	-	2-1/8	1-3/8	2-1/4	7/8	1-5/8	3/8

NEW!

Upgraded 17000 Series Pump

- Upgraded Water Seal
 - Spline Impeller
 - Robust Bearing Housing/Body
 - Upgraded Oil Seal
 - O-ring Sealed Gasket for Mounting
 - Increased Bearing/Shaft Size
 - Robust Wear Plate
 - G1730 replaces P1727X, P1730X, P1731X
 - G1732* replaces P1710X, P1726X, P1732X
- * Gear not included.

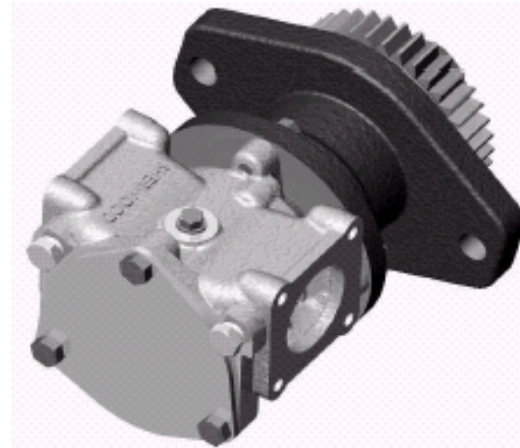

Phone: 800-225-0004 Fax: 908-486-1056
e-mail: sales@sealandpower.com

Engine Specified Pumps

**Model D55, D60,
 D65, D75
 Chrysler**



**Model E35
 Crusader**



**Model G65
 Perkins**



**Model G155
 Mercruiser/StarPower**



**Model G5, G7,
 G7B, G50
 Chrysler**



**Model G20, G21
 Pleasurecraft**



**Model G30-2,
 G30-2B, G45-1
 ChrisCraft**



**Model G151, G157
 StarPower &
 MarinePower**

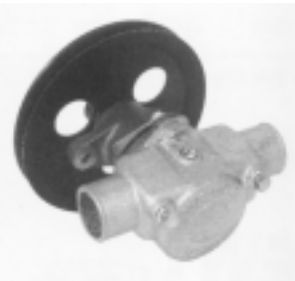

**Model GC1, GC4, GC5
 Cummins**



**Model J70, L80
 Commander**



**Model K75B, L10B
 Onan**



**Model M71
 Cummins**



The #1 Reason for Premature Engine Wear Is Overheating.

Phone: 800-225-0004 ☎ Fax: 908-486-1056
e-mail: sales@sealandpower.com

SHERWOOD

Manufacturer's Original Equipment

**Model G9901
 OMC/Volvo**

**Model G9903
 OMC/Volvo**

**Model G1503
 Cummins**

**Model G906, G907
 Kohler**

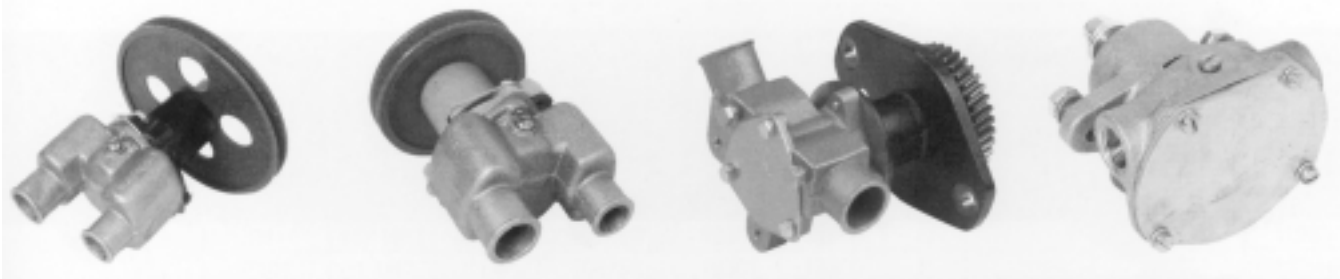

**Model G907P
 Kohler**

**Model H5
 Perkins**

**Model N10360GX
 ChrisCraft**

**Model P105
 Volvo, Indmar,
 MarinePower, etc.**

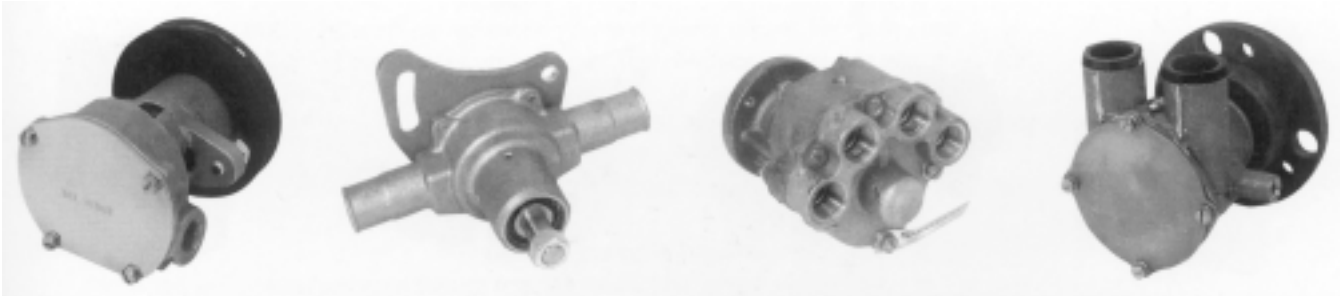

**Model R30G, R30G-1
 Westerbeke**

**Model R50G,
 R10870G
 Westerbeke**

**Model R991
 Yamaha**

**Model RPBC
 Perkins**

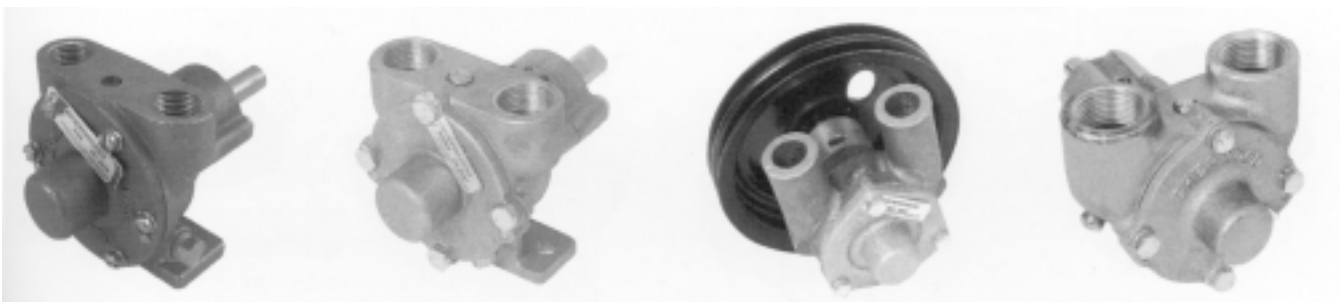

To Maintain Performance, Insist Upon Original Engine Specified Sherwood Products.

Phone: 800-225-0004 ☎ Fax: 908-486-1056
e-mail: sales@sealandpower.com

Engine Specified Pumps

Manufacturer's Original Equipment

Model G701
Onan



Model G1006
Onan



Model G1801, G1805
Caterpillar



Model G1804,
G1806, G18061
Caterpillar



Model G1807, G18071
Caterpillar



Model G1808, 18081
Caterpillar



Model G1810
Cummins



Model P176
Caterpillar



Model P1710,
P1726, P1732
Caterpillar



Model P1711, P1719
JohnDeere



Model P1716,
P1722, P173
Cummins



Model P1727,
P1730, P1731
Cummins



The #1 Reason for Premature Engine Wear Is Overheating.
 To Maintain Performance, Insist Upon Original Engine Specified Sherwood Products.

Phone: 800-225-0004 ☎ Fax: 908-486-1056
 e-mail: sales@sealandpower.com