

**Original equipment BMW auxiliary marine diesel engine parts available for models D7, D12, D35 & D50.**

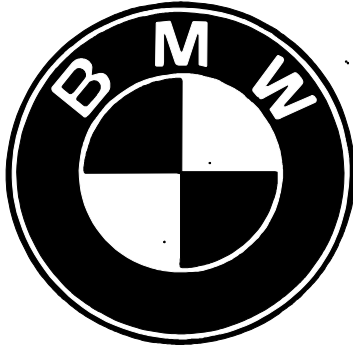

**BMW MARINE**

**We offer a complete line of original equipment and replacement parts for BMW auxiliary marine diesel engines.**

**Parts listed here are the most commonly requested. In addition, we have hundreds of other parts in stock ready for immediate shipment.**

**Call us today to keep your engine in tip-top shape!**

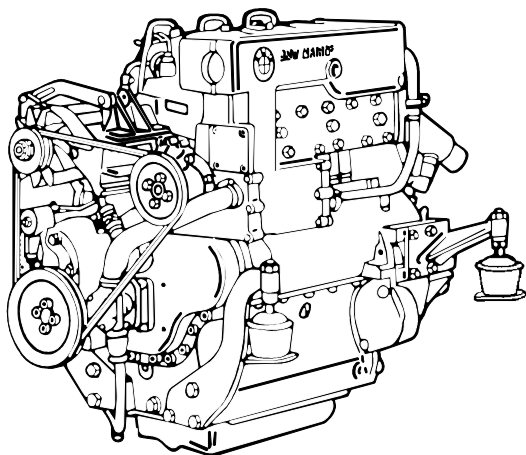

	<b>D-7</b>	<b>D-12</b>
Air Filter	13 71 1 329 269	13 71 1 329 269
Fuel Filter	13 32 1 329 270R	13 32 1 329 270R
Water Pump	17 11 1 333 602	17 11 1 333 602
Water Pump Impeller	17 11 1 329 158	17 11 1 329 158
Water Pump Gasket	17 11 1 329 161	17 11 1 329 161
Zinc Anode	17 11 1 329 197R	17 11 1 329 197R
Thermostat	17 11 1 329 391	17 11 1 329 391
Thermostat O-Ring	17 11 1 329 064	17 11 1 329 064
Fuel Pump Repair Kit	13 31 1 331 041	13 31 1 331 041
Injector Nozzle	13 53 1 329 669	13 53 1 329 669
Injector Nozzle Seal	13 53 1 329 670	13 53 1 329 496 13 53 1 329 497
Stator	12 31 1 334 007	12 31 1 334 007
Regulator Cut-Out	12 32 1 334 008	12 32 1 334 008
Pulse Transmitter	13 32 1 334 009	12 32 1 334 009
Upper Gasket Set	11 12 1 763 138	11 12 1 763 139
Exhaust Manifold Kit	11 62 1 763 094K	11 62 1 763 096K
Parts Manual	01 09 2 128 038R	01 09 2 128 038R
Shop Manual	01 51 2 128 180R	01 51 2 128 182R
Service & Adjustment Manual	96 00 0 000 666R	96 00 0 000 666R

	<b>D-35</b>	<b>D-50</b>
Air Filter	13 72 1 329 294	13 72 1 257 060
Fuel Filter	13 32 1 329 270R	13 32 1 329 270R
Oil Filter	11 42 1 761 087	11 42 1 761 087
Sea Water Pump	17 11 1 333 640	17 11 1 333 640
Sea Water Pump Impeller	17 11 1 331 424	17 11 1 331 424
Sea Water Pump Gasket	17 11 1 331 427	17 11 1 331 427
Circulating Water Pump (FWC)	11 51 1 333 330	11 51 1 333 330
Zinc Anode	17 11 1 329 197R	17 11 1 329 197R
Thermostat (FWC)	11 53 1 328 591	11 53 1 328 591
Thermostat (RWC)	17 11 1 329 391	17 11 1 329 391
V-Belt (FWC)	12 31 1 333 332	12 31 1 333 332
V-Belt (RWC)	12 31 1 331 436	12 31 1 331 436
Fuel Pump	13 31 1 333 013A	13 31 1 333 013A
Shut Down Solenoid	12 14 1 333 921	12 14 1 333 921
Oil Cooler Assm.	11 44 1 761 720	11 44 1 761 720
Parts Manual	01 09 2 128 039R	01 09 2 128 039R1
Shop Manual	01 51 2 128 313R	01 51 2 128 313R

*K-Kit, R-Replacement/Reprint*

**Phone: 800-225-0004 ☎ Fax: 908-486-1056**  
**e-mail: sales@sealandpower.com**



## Adjustable Mounts

- Eliminate Metal to Metal Contact
- Designed for the Marine Environment
- Vertical Adjustment for Flexible Mounting
- Reduce Noise and Vibration, Absorbs Shock

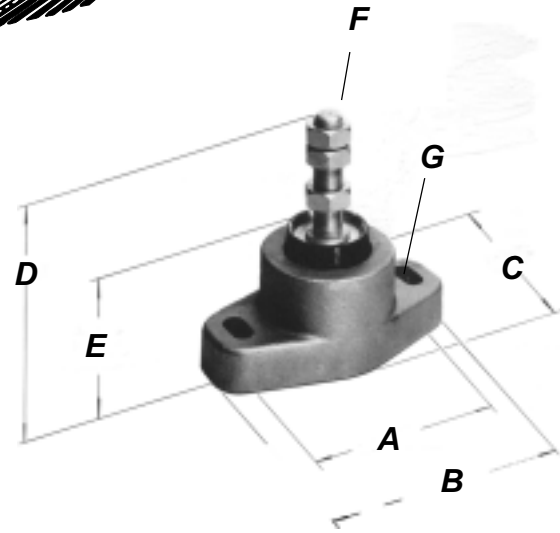

Part #	Dimensions							
	A	B	C	D	E	F Stud Dia.	G Mtg. Bolt	Engine Weight(lbs) (4 Pt. Mtg.)
DF-100 (2M1)	4"	5"	2 3/4"	4"	1 7/8"	5/8"-18	3/8"	500-850
DF-110	4"	5"	2 3/4"	4"	1 7/8"	3/4"-16	3/8"	500-850
DF-206 (2M5)	4"	5"	2 3/4"	4 3/16"	2 1/8"	5/8"-18	3/8"	850-1100
DF-216 (2M6)	4"	5"	2 3/4"	4 3/16"	2 1/8"	3/4"-16	3/8"	850-1100
DF-236-M1	5"	6 1/2"	3 3/8"	4 1/2"	2 1/2"	3/4"-16	1/2"	1100-1500
DF-237-M1	5"	6 1/2"	3 3/8"	4 1/2"	2 1/2"	3/4"-16	1/2"	1500-1800
DF-238-M1	5"	6 1/2"	3 3/8"	4 1/2"	2 1/2"	3/4"-16	1/2"	1800-2200
DF-2204-2	4"	5"	2 3/4"	4 7/16"	2 3/8"	5/8"-18	3/8"	Up To 150
DF-2205-2	4"	5"	2 3/4"	4 7/16"	2 3/8"	5/8"-18	3/8"	150-350
DF-2207-2	4"	5"	2 3/4"	4 7/16"	2 3/8"	5/8"-18	3/8"	550-750
DF-3304-3	4 1/2"	5 3/4"	3 3/16"	4 7/8"	2 7/8"	3/4"-16	7/16"	750-950
DF-3305-3	4 1/2"	5 3/4"	3 3/16"	4 7/8"	2 7/8"	3/4"-16	7/16"	950-1100
DF-3306-3	4 1/2"	5 3/4"	3 3/16"	4 7/8"	2 7/8"	3/4"-16	7/16"	1100-1400
DF-3307-3	4 1/2"	5 3/4"	3 3/16"	4 7/8"	2 7/8"	3/4"-16	7/16"	1400-1600
DF-4405-4	5"	6 3/4"	3 11/16"	5 3/4"	3 1/2"	1"-14	1/2"	1400-1800
DF-4406-4	5"	6 3/4"	3 11/16"	5 3/4"	3 1/2"	1"-14	1/2"	1800-2200
DF4407-4	5"	6 3/4"	3 11/16"	5 3/4"	3 1/2"	1"-14	1/2"	2200-2500
DF4408-4	5"	6 3/4"	3 11/16"	5 3/4"	3 1/2"	1"-14	1/2"	2500-2800

Many other sizes are available. Call us with your requirements.

Phone: 800-225-0004 ☎ Fax: 908-486-1056  
e-mail: sales@sealandpower.com



## Exhaust, Fuel & Water Hose



### HARDWALL WATER HOSE Series 100

Premium quality marine water hose suitable for a variety of applications including engine water intake and circulation, bilge discharge, livewell systems and other non-fuel uses. A fully embedded helical wire provides strength and flexibility. Resists heat, ozone, mild acids, bilge oils and engine water. Color coded with green strip brand.

Part #	I.D.	O.D.
EW 58	1/2"	7/8"
EW 59	5/8"	1"
EW 60	3/4"	1-7/64"
EW 61	7/8"	1-7/32"
EW 62	1"	1-11/32"
EW 63	1-1/8"	1-15/32"
EW 64	1-1/4"	1-5/8"
EW 65	1-3/8"	1-47/64"
EW 66	1-1/2"	1-55/64"
EW 67	1-5/8"	2-1/32"
EW 68	1-3/4"	2-11/64"
EW 69	1-7/8"	2-3/8"



### HARDWALL MARINE EXHAUST HOSE Series 250

Type certified for wet exhaust service. Heavy wall construction with multiple plies of nylon spiral cord prevents shock, wall collapse, panting and vibration. Resists engine exhaust, high temperatures and ozone. Wire reinforcement provides additional strength for longer connections with excellent flexibility. Recommended for runs longer than four times the inside diameter of the hose. Color coded with blue strip brand. Meets SAE J2006 standard.

Part #	I.D.	O.D.
EE 207	2"	2-13/32"
EE 210	2-3/8"	2-3/4"
EE 212	2-1/2"	2-15/16"
EE 212	2-7/8"	3-7/16"
EE 213	3"	3-9/16"
EE 213A	3-1/8"	3-45/64"
EE 214	3-1/2"	4-3/32"
EE 215	4"	4-11/32"
EE 220	5"	5-3/4"

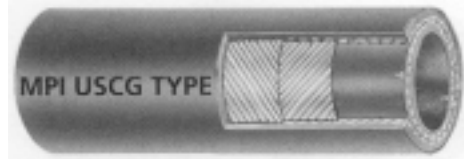

### FUEL TANK FEED AND VENT HOSE USCG TYPE A1 AND A2 Series 350

Premium quality fire-retardant fuel hose meets or exceeds SAE J1527 and all USCG requirements. Resistant to gasoline, diesel and alcohol-enhanced fuels. Braided reinforcement provides excellent flexibility and bend radius.

Part #	I.D.	O.D.
EF 102	3/8"	25/32"
EF 110	5/8"	1-1/64"

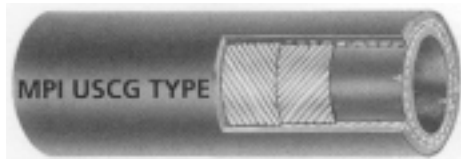

### FUEL TANK FILL HOSE USCG TYPE A2 Series 350

Premium quality fire-retardant fuel hose meets or exceeds all requirements of new ISO 7840 and SAE J1527 standards required by USCG, ABYC and NMMA. Resistant to gasoline, diesel and alcohol-enhanced fuels. Reinforced with helical wire between plies of nylon spiral cord. Provides strength and flexibility. Resistant to abrasion, heat and ozone.

Part #	I.D.	O.D.
EF 111	1-1/2"	2"

\*Many other sizes and types of hoses are available. Call for more info.

Phone: 800-225-0004  Fax: 908-486-1056  
e-mail: sales@sealandpower.com



# MARINE DISTRIBUTORS

## YL Series Point-Type Distributors

Using new materials and technology, Mallory's YL Series Distributor delivers more performance and reliability for today's marine performance engines. This proven ignition system drives both original equipment and high performance coils, including Mallory's PROMASTER® Coil and High Performance Coil.

### Features At A Glance:

- Stabilized points eliminate point float and bounce
- High dielectric condenser with brass case eliminates corrosion
- Mylar insulation provides greater protection against current leaks and shorting
- Super-Duty cap and rotor
- Self-lubricating bushings



Mallory's YLU series UNILITE and YLM series magnetic breakerless electronic distributors are also available. Call for more info.

### MARINE APPLICATIONS

#### UNIVERSAL

#### standard rotation, stack cap

CYL.	ENGINE APPLICATION	BREAKERLESS ELECTRONIC DISTRIBUTORS				
		BREAKER POINT (SINGLE POINT) NON-TACH DRIVE	YLU SERIES UNILITE® IGNITION NON-TACH DRIVE	YLU SERIES UNILITE® ELEC. IGNITION TACH DRIVE	YLM SERIES MAGNETIC BREAKERLESS NON-TACH DRIVE	YLM SERIES MAGNETIC BREAKERLESS TACH DRIVE
<b>CHEVROLET</b>						
V8/RH	262-454, 502 Engines except 348, 409, and Tall Block Engines	YL624AV	YLU624AV	YLU623AV	YLM624AV	YLM623AV
V8/RH	Tall Block Engines	YL590AV	YLU590AV	-	YLM590AV	-
L6/RH	194, 230, 250 and 4.8L/292 Engines	YL676AV	YLU676AV	-	YLM676AV	-
V6/RH	4.3L/262 Engines (EVEN Fire)	YL700AV	YLU700AV	-	YLM700AV	-
V6/RH	200 and 229 Engines (SEMI-EVEN Fire)	-	-	-	-	-
L4/RH	153 Engines	YL673AV	YLU673AV	-	YLM673AV	-
<b>CHRYSLER</b>						
V8/LH	413, 426 (Wedge) and 440 "RB" Engines	YL578AV	YLU578AV	-	YLM578AV	-
V8/LH	350, 361, 383 and 400 "B" Engines	YL577AV	YLU577AV	-	YLM577AV	-
V8/RH	273, 318 (67 and up), 340 and 360 "LA" Engines	YL579AV	YLU579AV	-	YLM579AV	-
<b>FORD MOTOR COMPANY</b>						
V8/LH	351C, 351M, 400, 429 and 460 Engines	YL567EV	YLU567EV	-	YLM567EV	-
V8/LH	351W Engines	YL554CV	YLU554CV	YLU555CV	YLM554CV	YLM555CV
V8/LH	221, 255, 260, 289 and 302 Engines	YL512CV	YLU512CV	YLU513AV	YLM512CV	YLM513AV
L4/RH	2.3L/2300cc Engines (Not HSC)	YL621CV	YLU621CV	-	YLM621CV	-
<b>OLDSMOBILE</b>						
V8/LH	330, 350, 400, 403, 425 and 455 Engines	YL501GV	YLU501GV	YLM501GV	-	-

#### UNIVERSAL

#### standard rotation, flat cap

CYL.	ENGINE APPLICATION	BREAKER POINT (SINGLE POINT) NON-TACH DRIVE	YLU SERIES IGNITION NON-TACH DRIVE	YLU SERIES ELEC. IGNITION TACH DRIVE	YLM SERIES BREAKERLESS NON-TACH DRIVE	YLM SERIES BREAKERLESS TACH DRIVE
<b>CHEVROLET</b>						
V8/RH	262-454, 502 Engines except 348, 409, and Tall Block Engines	YL520CV	YLU520CV	YLU356AV	YLM520CV	YLM356AV
<b>FORD MOTOR COMPANY</b>						
V8/LH	351C/M, 400, 429 and 460 Engines	YL560AV	YLU560AV	YLU561AV	-	-
V8/LH	351W Engines	YL558AV	YLU558AV	YLU559AV	-	-
V8/LH	221, 255, 260, 289 and 302 Engines	YL445JV	YLU445JV	YLU519AV	-	-

Most popular Mallory Marine Distributors are also available for use in opposite rotation applications.

Many original equipment Mallory Marine distributors were equipped with modified advance curves as specified by the marine engine company. The distributors above can be tailored to match a specific advance curve with the purchase of an Advance Curve Kit #29014

Phone: 800-225-0004 ☎ Fax: 908-486-1056  
e-mail: sales@sealandpower.com



# SERVICE PARTS

## MALLORY POINT TYPE MARINE AND INDUSTRIAL DISTRIBUTOR TUNE-UP PARTS

DISTRIBUTOR PART NO.	CYLINDER ROTATION	DESCRIPTION	CAP	ROTOR	POINT	CONDENSER	UNILITE® BREAKERLESS CONVERSION	E-SPARK Electronic Conversion Kits
YD or YL350 (ALL)	8LH	Eaton Mfg./Dearborn Marine	221B	319	25042	400	559	61005M
YD or YL356 (ALL)	8RH	Owens Yacht	221B	319	25042	400	559	61005M
YD or YL362 (ALL)	8LH	Eaton Mfg./Dearborn Marine	221B	319	25042	400	559	61005M
YD or YL387 (ALL)	8LH	Eaton Mfg./Dearborn Marine	209D	309	25042	400	558	61004M
YL445 (ALL)	8LH	Eaton Mfg./Dearborn Marine	221B	319	25042	400	559	61005M
YL486 (A or B)	6RH	Crusader Marine	226B	320M	25042	400	(NA)	(NA)
YL487 (ALL)	8RH	Crusader Marine	209D	309	25042	400	558	61004M
YL501 (ALL)	8LH	Hardin Marine	209D	309	25042	400	558	61004M
YL502 (ALL)	8LH	Chris Craft	221B	319	25042	400	559	61005M
YL507 (ALL)	6RH	Ford	226B	320M	25042	400	(NA)	(NA)
YL512 (ALL)	8LH	Dearborn Marine	209D	309	25042	400	558	61004M
YL513 (ALL)	8LH	289-302 Ford	209D	309	25042	400	558	61004M
YL519 (ALL)	8LH	Eaton Mfg./Dearborne Marine	221B	319	25042	400	559	61005M
YL520 (ALL)	8RH	OMC, Guardin, Hardin, Panther Marine	221B	319	25042	400	559	61005M
YL529 (ALL)	8RH	Crusader Marine	221B	319	25042	400	559	61005M
YL539 (ALL)	8RH	Chris Craft, Crusader, 327F	221B	319	25042	400	559	61005M
YL554 (ALL)	8LH	351W Ford	209D	309	25042	400	558	61004M
YL555 (ALL)	8LH	351W Ford	209D	309	25042	400	558	61004M
YL558 (ALL)	8LH	351W Ford	221B	319	25042	400	559	61005M
YL566 (ALL)	8RH	Chris Craft, Crusader, 327Q	221B	319	25042	400	559	61005M
YL567 (ALL)	8LH	351C Ford	209D	309	25042	400	558	61004M
YL585 (ALL)	8RH	Chris Craft	221B	319	25042	400	559	61005M
YL590 (ALL)	8RH	Tall Block Chevrolet	209D	309	25042	400	558	61004M
YL620A	6RH	Waukesha	245B	345	25042	400	(NA)	(NA)
YS621CV	4RH	OMC	271B	309	25042	400	(NA)	(NA)
YL623 (ALL)	8RH	Crusader, Chris Craft	209D	309	25042	400	558	61004M
YL624 (ALL)	8RH	OMC, Crusader, Mercury, Pleasurecraft	209D	309	25042	400	558	61004M
YS624 (ALL)	8RH	Hardin Marine	209D	309	25042	400	(NA)	(NA)
YL648AV	4RH	1977-80 Mercury Marine Aluminum Block	271B	309	25042	400	(NA)	(NA)
YL664 (ALL)	4RH	Waukesha	241 (CAP & RTR KIT)	309	25042	400	(NA)	(NA)
YL665 (ALL)	4RH	Waukesha	271B	309	25042	400	(NA)	(NA)
YL666A	6RH	Waukesha, White Farm	270B	309	25042	400	(NA)	(NA)
YL670 (ALL)	8RH	OMC, Crusader, Mercury	209D	309	25042	400	511D	511D
YL673 (ALL)	4RH	Chevrolet 153	271B	309	25042	400	(NA)	(NA)
YL675BV	6RH	Crusader Inline 6 (Chev)			25042	400		
YL677 (ALL)	6RH	Chevrolet V6 Odd-Fire	270B	310	25042	400		
YL679A	4RH	Hyster, Ford E1JL12100AA	271B	309	25042	400		
YL694AV	4RH	Pleasurecraft, Mitsubishi Marine	271B	309	25042	400		
YL698A	6RH	Waukesha	270B	309	25042	400		
YL700 (ALL)	6RH	Chevrolet V6 Even-Fire	270B	309	25042	400		
YS701AVC	4LH	Ford E6JL12100AC	225B	320	25042	400	511	511
YL703AV	8RH	Crusader	209D	309	25042	400		
YL711 (ALL)	3	Ford Tractor		309	25042	400		

## MALLORY YLM AND YLU DISTRIBUTOR TUNE-UP PARTS

DISTRIBUTOR PART NO.	DESCRIPTION	YLM SERIES			YLU SERIES		
		CAP	ROTOR	MODULE	CAP	ROTOR	MODULE
YLM or YLU 356 (ALL)	Owens Yacht	221B	318	609	221B	360	605
YLM or YLU 445 (ALL)	Eaton Mfg./Dearborn Marine	221B	318	609	221B	360	605
YLM or YLU 501 (ALL)	Hardin Marine	209D	309	609	209D	360	605
YLM or YLU 502 (ALL)	Chris Craft	221B	318	609	221B	360	605
YLM or YLU 512 (ALL)	Dearborn Marine	209D	309	609	209D	335	605
YLM or YLU 519 (ALL)	Eaton Mfg./Dearborn Marine	221B	318	609	221B	360	605
YLM or YLU 520 (ALL)	OMC, Guardin, Hardin, Panther Marine	221B	318	609	221B	360	605
YLM or YLU 554 (ALL)	351W Ford	209D	309	609	209D	335	605
YLM or YLU 558 (ALL)	351W Ford	221B	318	609	221B	360	605
YLM or YLU 566 (ALL)	Chris Craft 327Q	221B	318	609	221B	360	605
YLM or YLU 567 (ALL)	351 C Ford	209D	309	609	209D	335	605
YLM or YLU 577 (ALL)	V8 Chrysler	209D	309	609	209D	335	605
YLM or YLU 578 (ALL)	V8 Chrysler	209D	309	609	209D	335	605
YLM or YLU 579 (ALL)	V8 Chrysler	209D	309	609	209D	335	605
YLM or YLU 585 (ALL)	Chris Craft	221B	318	609	221B	360	605
YLM or YLU 590 (ALL)	Tall Block Chevrolet	209D	309	609	209D	335	605
YLM or YLU 621CV	OMC	271B	309	609	271B	340	605
YLM or YLU 623 (ALL)	Crusader, Chris Craft	209D	309	609	209D	335	605
YLM or YLU 624 (ALL)	OMC, Crusader, Mercury, Pleasurecraft, Hardin Marine	209D	309	609	209D	335	605
YLU 670 (ALL)	OMC, Crusader, Mercury, Pleasurecraft, Hardin Marine	-	-	-	209D	335	605
YLM or YLU 673 (ALL)	153 Chevy	271B	309	609	271B	340	605
YLM or YLU 676 (ALL)	Inline 6 Chevy	270B	309	609	270B	339	605
YLM or YLU 700 (ALL)	262 V6 Chevrolet	270B	309	609	270B	339	605
YLU 710A	Zaball / Onan	-	-	-	225B	337	605
YLU 714A	Waukesha	-	-	-	270B	339	605



# DISTRIBUTOR ACCESSORIES

## FOR MALLORY DISTRIBUTORS

### UNILITE® CONVERSION KITS FOR POINT DISTRIBUTORS

Put an end to high maintenance Point Ignition Systems by installing a proven Mallory Unilite® Ignition Conversion Kit.

**Features At A Glance:**

- Improves performance and fuel efficiency
- Easy to install with simple hand tools
- Reduced maintenance
- Available for all popular 12-volt negative ground domestic cars and trucks
  - Mallory 4, 6, and 8 cylinder Point Type Automotive, Industrial, and Marine Distributors – Mechanical Advance only

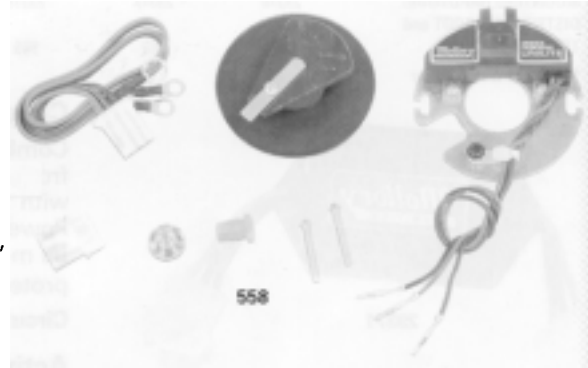

#### KIT APPLICATIONS

For Mallory Automotive, Industrial, and Marine Distributors with Mechanical Advance only

Cyl	Distributor Type	Year	Description	Use Kit No.
8	Mallory	All	YL, HP, 25 & 26 Series with Stack Style Caps	558
8	Mallory	All	YL, HP, 25 & 26 Series with Flat Style Caps	559



### E SPARK® CONVERSION KITS FOR POINT DISTRIBUTORS

Put an end to high maintenance Point Ignition Systems by installing a proven Mallory E Spark Ignition Conversion Kit. By utilizing specialized electronic circuitry and a infrared signal, ignition timing is stable from 1 RPM through 10,000!

**Features At A Glance:**

- More accurate ignition timing than any other type of system- Period!
- Improves performance and fuel efficiency
- Easy to install with simple hand tools
- Reduced maintenance
- Latest Thermal Clad based surface mount construction for maximum dependability and long life
- Available for all popular 12-volt negative ground domestic cars and trucks
  - Mallory 4, 6, and 8 cylinder Point Type Automotive, Industrial, and Marine Distributors – Mechanical Advance only

#### KIT APPLICATIONS

For Mallory Automotive, Industrial, and Marine Distributors with Mechanical Advance only

Cyl	Distributor Type	Year	Description	Use Kit No.
8	Mallory	All	YL, HP, 25 & 26 Series with Stack Style Caps	61004M
8	Mallory	All	YL, HP, 25 & 26 Series with Flat Style Caps	61005M



# COILS AND ACCESSORIES

## Universal Street Performance Chrome Ignition Coil For Points Type Distributors

- Universal, 12-volt coil improves performance of breaker point ignition systems
- Oil-filled design and arc-resistant alkyd top deliver superior performance, insulation and cooling
- Fits most original equipment coil brackets, or use Mallory Super Duty Coil Bracket



Universal Street Performance Chrome Ignition Coil For Points Type Distributors . . . . . 29217

## Universal Street Performance Chrome Electronic Ignition Coil

- Universal, 12-volt coil features an oil-filled design and arc resistant alkyd top for superior performance, insulation and cooling. Delivers optimum performance when used with:
  - Mallory UNILITE® or Magnetic Breakerless Distributors equipped with a capacitive discharge ignition
  - Mallory HYFIRE® IV and VI Series Electronic Ignition Controls
  - Original equipment breakerless electronic ignition systems
- Fits most original equipment coil brackets, or use Mallory Super Duty Coil Bracket
- Not for use with Mallory HYFIRE® Electronic Ignition Control P/N 629, 630, 693, 29026, 29062A, 29028, 29029, 29037, or any other high energy, inductive storage ignition system

Universal Street Performance Chrome Electronic Ignition Coil . . . . . 29216

## Super Duty Coil Bracket

Allows easy mounting of most original equipment and performance coils, including Mallory's chrome coils (Part Nos. 29216 and 29217).

Super Duty Coil Bracket (Dichromate/Gold) . . . . . 29221

Super Duty Coil Bracket (Chrome) . . . . . 29224

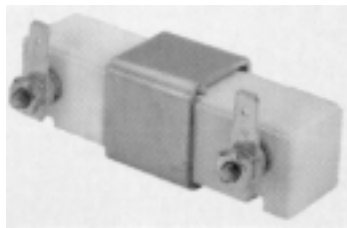
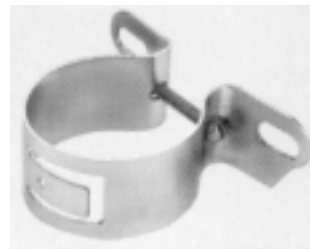

## Ballast Resistor

Heavy duty porcelain resistor with threaded terminal connectors is rated at 200 watts and 0.75 – 1.5 ohms. Variable resistance values improve cold weather starting. Direct replacement for old Mallory Part Numbers 25750-38 and 28127. Designed for use with E-spark, MBI and UniLite distributors (Ex. w/HyFire CD Ignitions)

Ballast Resistor . . . . . 700

## SPRINT WIRE® 8MM YELLOW SILICONE JACKETED WIRE

### Features At A Glance:

- High-tech CIF (Carbon Impregnated Fiber) core for great energy delivery at an affordable price
- CIF core provides RFI suppression for even the most sensitive on-board electronics, such as electronic ignition, sound systems, or computer controls
- 8MM ozone-resistant black silicone jacket repels water, oil, grease, and fuel and withstands temperatures up to 500 degrees
- Available in 3 universal V8 kits

V8 With Straight Plug Boots . . . . . 765M

V8 With 90 Degree Plug Boots . . . . . 766

V8 With 45 Degree Plug Boots . . . . . 701

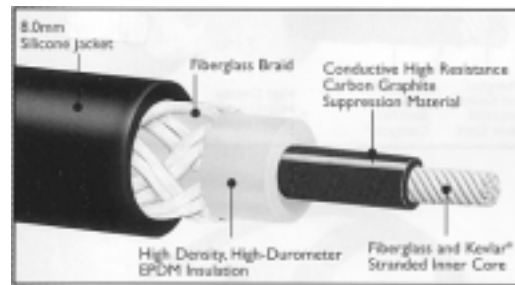



OEM Style Replacements for:

**MERCURISER**

Thermostat components for GM V8 engines with LOG STYLE manifolds.

Necessary pipe plugs are included.

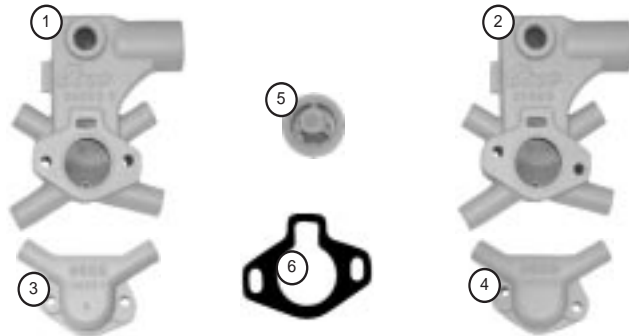

1. **MC553-SB** **Thermostat base.** Fits engines with log style manifolds. Fits small block GM, V8 305 - 350 cu.in. Replaces Mercruiser # 78984.
2. **MC553-BB** **Thermostat base.** Fits engines with log style manifolds. Fits big block GM 454 cu.in. Replaces Mercruiser # 78985.
3. **MC55-TSB** **Top Cover.** Fits small block thermostat housings. Replaces Mercruiser # 47441.
4. **MC55-TBB** **Top Cover.** Fits big block thermostat housings. Replaces Mercruiser # 47442.
5. **143-DEG** **Thermostat element,** 143° for raw water cooling. Replaces Mercruiser # 59137.
6. **48818** **Gasket,** top cover to base for log style manifolds. Replaces Mercruiser # 27-48818. Use with MC553-SB or MC553-BB thermostat bases.

Thermostat components for GM V8 engines with CENTER RISER STYLE manifolds.

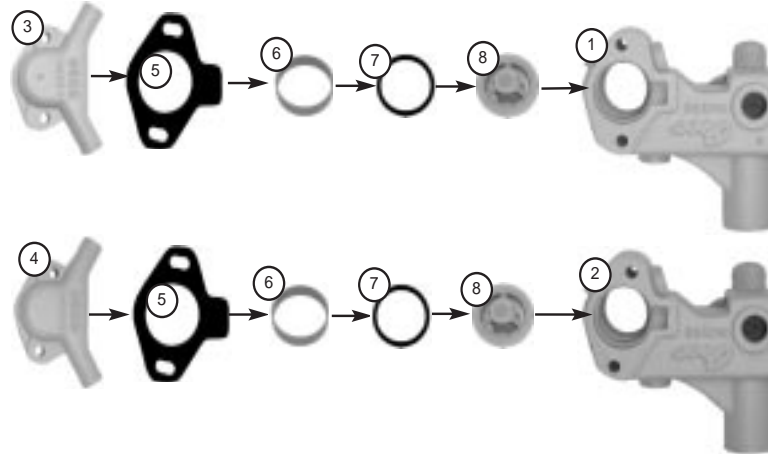

1. **MC552-SB** **Thermostat base.** Fits engines with center riser style manifolds. Fits small block GM, V6 and V8 305 - 350 cu.in. Replaces Mercruiser # 87290. Uses original Tee fitting.
2. **MC552-BB** **Thermostat base.** Fits engines with center riser style manifolds. Fits big block GM 454 cu.in. Replaces Mercruiser # 90736. Uses original Tee fitting.
3. **MC55-TSB** **Top Cover.** Fits small block thermostat housings. Replaces Mercruiser # 47441.
4. **MC55-TBB** **Top Cover.** Fits big block thermostat housings. Replaces Mercruiser # 47442.
5. **41812** **Gasket,** top cover to base for center riser style manifolds. Replaces Mercruiser # 27-41812. Use with MC552-SB or MC552-BB thermostat bases.
6. **47508** **Sleeve,** thermostat element. Replaces mercruiser # 23-47508. Use with MC552-SB or MC552-BB thermostat bases.
7. **47510** **Gasket,** sleeve to thermostat element. Replaces Mercruiser #27-47510. Use with MC552-SB or MC552-BB thermostat bases.
8. **143-DEG** **Thermostat element,** 143° for raw water cooling. Replaces Mercruiser # 59137.





## Thermostat Housing Assembly

### Raw Water, Dual Pump.

Osco thermostat assemblies provide even heat distribution and temperature control for most commonly used raw water cooled marine engines. They are approved by GM and Ford. By using both the automotive style circulator and raw water pump, OSCO thermostat assemblies assure even heat distribution as well as full manifold and tailpipe cooling, even when the engine is cold and the thermostat is closed. Osco thermostat assemblies can be used with most OEM raw water pumps.

1

**GM Inline 4 and 6 cylinder.**  
Fits 153 - 292 cu.in. Chevrolet engines.

1. **CY55M** Thermostat Housing Assembly.  
1a. **F55H** Thermostat Cover.  
1b. **F55-G** Gasket, thermostat cover to base.  
1c. **143-DEG** Element, 143° for raw water cooling.  
1d. **F55BY** Thermostat Base.

2

**GM Small Block V6 and V8.**  
Fits 229 - 400 cu.in. Chevrolet engines.

2. **CV55** Thermostat Housing Assembly.  
2a. **F55O** Thermostat Cover.  
2b. **F55-G** Gasket, thermostat cover to base.  
2c. **143-DEG** Element, 143° for raw water cooling.  
2d. **F55BO** Thermostat Base.

3

**GM Big Block V8**  
Fits 348 - 454 cu.in. Chevrolet engines.

3. **CW55** Thermostat Housing Assembly.  
3a. **F55O** Thermostat Cover.  
3b. **F55-G** Gasket, thermostat cover to base.  
3c. **143-DEG** Element, 143° for raw water cooling.  
3d. **F55BO-CW** Thermostat Base.

4

**Ford Small Block V8.**  
Fits 221 - 351 cu.in. Ford engines.

4. **FL55** Thermostat Housing Assembly.  
4a. **F55** Thermostat Cover.  
4b. **F55-G** Gasket, thermostat cover to base.  
4c. **143-DEG** Element, 143° for raw water cooling.  
4d. **F55C** Thermostat Base.

5

**Ford Big Block V8**  
Fits 429 - 460 cu.in. Ford engines.

5. **FH55** Thermostat Housing Assembly.  
5a. **F55H** Thermostat Cover.  
5b. **F55-G** Gasket, thermostat cover to base.  
5c. **143-DEG** Element, 143° for raw water cooling.  
5d. **F55HB** Thermostat Base.

6

**Oldsmobile V8**  
Fits 260 - 455 cu.in. Oldsmobile engines.

6. **OL55** Thermostat Housing Assembly.  
6a. **F55O** Thermostat Cover.  
6b. **F55-G** Gasket, thermostat cover to base.  
6c. **143-DEG** Element, 143° for raw water cooling.  
6d. **F55BO-OL** Thermostat Base.

## Flame Arresters

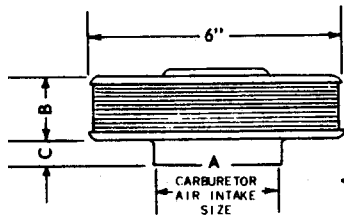

MODEL	A	B	C
2H15	2 5/8	1 1/2	1/2
2H16	3 1/8	1 1/2	1/2
2H17	4 1/4	1 1/2	5/8
2H18	5	1 1/2	5/8
*2H20	5	2 1/2	0

\* SPECIAL FOR FORD AND HOLLEY.  
WIRE MESH ARRESTER SCREEN.

**2H1** Breather Hose Adaptor  
5/8" I.D. Hose

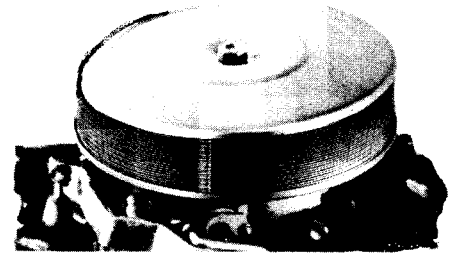

## Carburetor Wedges

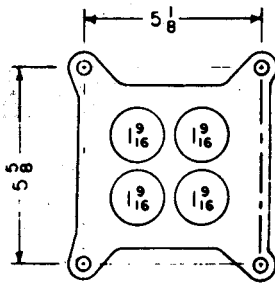

**M648**  
For AFB Carter as used by  
Ford; Holley; Ford/Autolite.

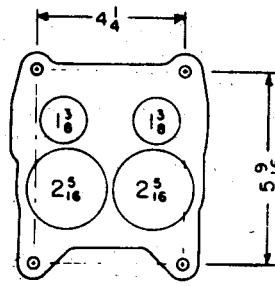

**B650**  
Rochester Quadrajets  
**B651**  
For Flywheel Forward  
Engine Installations

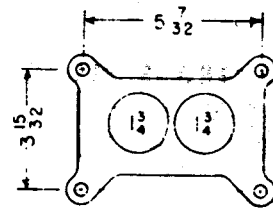

**V649**  
ABD Carter; Holley  
Ford/Autolite; Chrysler

\*approximately 8°

OEM Replacement for: **Chris Craft**

## INTAKE MANIFOLD

Aluminum



SIDE VIEW





Flywheel Forward, Low Profile

TOP VIEW

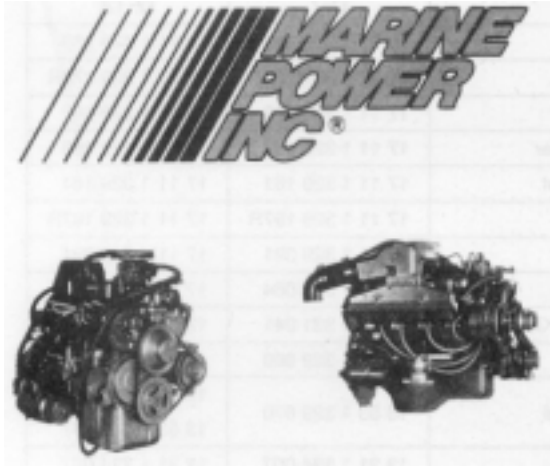

- 827-1621-CC** Aluminum intake manifold. Exact replacement for the low profile intake used on GM small block V8 flywheel forward engines marinized by Chris Craft.



  
**Crusader**  
MARINE ENGINES

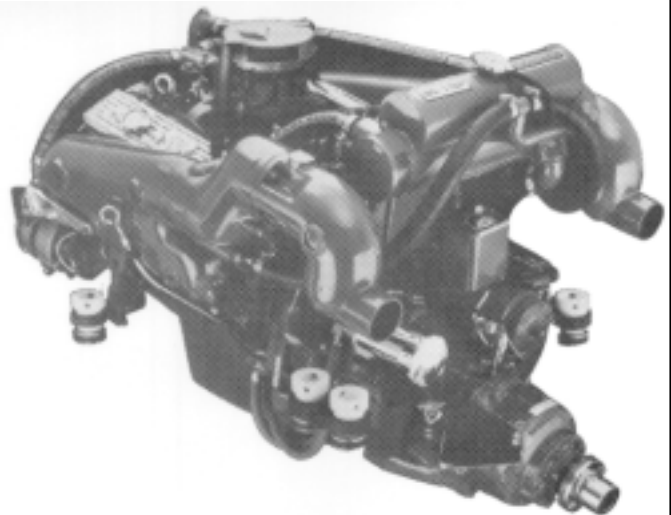

**LEHMAN  
POWER**

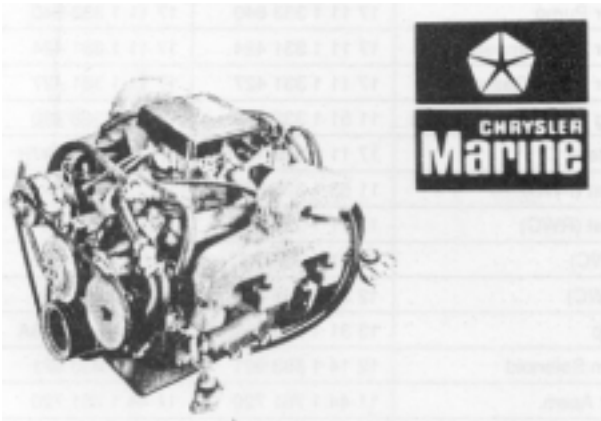

**US**  
**MARINE**  
**POWER**

*Chris + Craft*

**Replacement parts and accessories available for these popular brands. Advise year, make and model number with your inquiry.**

Phone: 800-225-0004 ☎ Fax: 908-486-1056  
e-mail: [sales@sealandpower.com](mailto:sales@sealandpower.com)