



OEM Style Replacements for:

MERCURISER

Thermostat components for GM V8 engines with LOG STYLE manifolds.

Necessary pipe plugs are included.

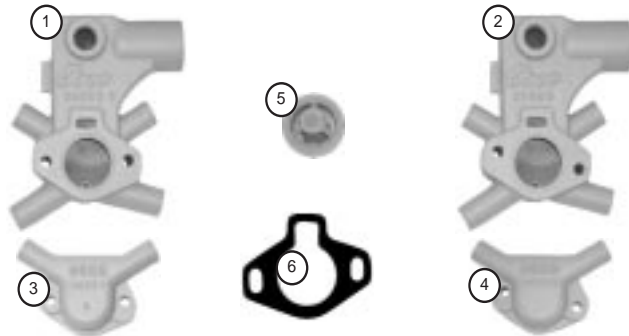

1. **MC553-SB** **Thermostat base.** Fits engines with log style manifolds. Fits small block GM, V8 305 - 350 cu.in. Replaces Mercruiser # 78984.
2. **MC553-BB** **Thermostat base.** Fits engines with log style manifolds. Fits big block GM 454 cu.in. Replaces Mercruiser # 78985.
3. **MC55-TSB** **Top Cover.** Fits small block thermostat housings. Replaces Mercruiser # 47441.
4. **MC55-TBB** **Top Cover.** Fits big block thermostat housings. Replaces Mercruiser # 47442.
5. **143-DEG** **Thermostat element,** 143° for raw water cooling. Replaces Mercruiser # 59137.
6. **48818** **Gasket,** top cover to base for log style manifolds. Replaces Mercruiser # 27-48818. Use with MC553-SB or MC553-BB thermostat bases.

Thermostat components for GM V8 engines with CENTER RISER STYLE manifolds.

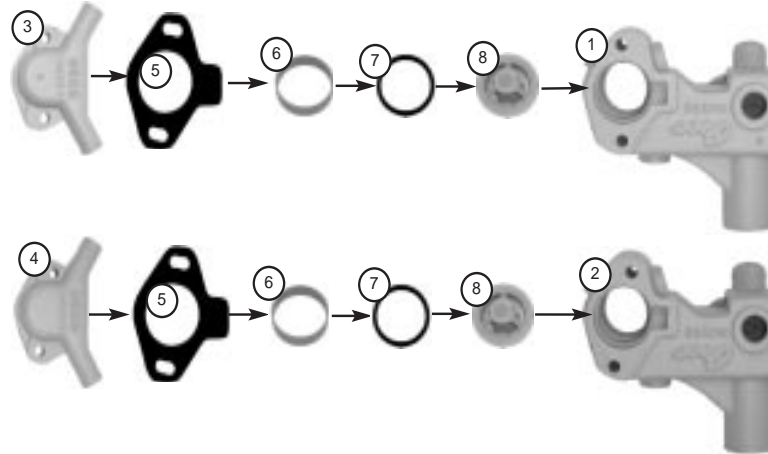

1. **MC552-SB** **Thermostat base.** Fits engines with center riser style manifolds. Fits small block GM, V6 and V8 305 - 350 cu.in. Replaces Mercruiser # 87290. Uses original Tee fitting.
2. **MC552-BB** **Thermostat base.** Fits engines with center riser style manifolds. Fits big block GM 454 cu.in. Replaces Mercruiser # 90736. Uses original Tee fitting.
3. **MC55-TSB** **Top Cover.** Fits small block thermostat housings. Replaces Mercruiser # 47441.
4. **MC55-TBB** **Top Cover.** Fits big block thermostat housings. Replaces Mercruiser # 47442.
5. **41812** **Gasket,** top cover to base for center riser style manifolds. Replaces Mercruiser # 27-41812. Use with MC552-SB or MC552-BB thermostat bases.
6. **47508** **Sleeve,** thermostat element. Replaces mercruiser # 23-47508. Use with MC552-SB or MC552-BB thermostat bases.
7. **47510** **Gasket,** sleeve to thermostat element. Replaces Mercruiser #27-47510. Use with MC552-SB or MC552-BB thermostat bases.
8. **143-DEG** **Thermostat element,** 143° for raw water cooling. Replaces Mercruiser # 59137.



Thermostat Housing Assembly

Raw Water, Dual Pump.

Osco thermostat assemblies provide even heat distribution and temperature control for most commonly used raw water cooled marine engines. They are approved by GM and Ford. By using both the automotive style circulator and raw water pump, OSCO thermostat assemblies assure even heat distribution as well as full manifold and tailpipe cooling, even when the engine is cold and the thermostat is closed. Osco thermostat assemblies can be used with most OEM raw water pumps.

1

GM Inline 4 and 6 cylinder.
Fits 153 - 292 cu.in. Chevrolet engines.

1. **CY55M** Thermostat Housing Assembly.
1a. **F55H** Thermostat Cover.
1b. **F55-G** Gasket, thermostat cover to base.
1c. **143-DEG** Element, 143° for raw water cooling.
1d. **F55BY** Thermostat Base.

2

GM Small Block V6 and V8.
Fits 229 - 400 cu.in. Chevrolet engines.

2. **CV55** Thermostat Housing Assembly.
2a. **F55O** Thermostat Cover.
2b. **F55-G** Gasket, thermostat cover to base.
2c. **143-DEG** Element, 143° for raw water cooling.
2d. **F55BO** Thermostat Base.

3

GM Big Block V8
Fits 348 - 454 cu.in. Chevrolet engines.

3. **CW55** Thermostat Housing Assembly.
3a. **F55O** Thermostat Cover.
3b. **F55-G** Gasket, thermostat cover to base.
3c. **143-DEG** Element, 143° for raw water cooling.
3d. **F55BO-CW** Thermostat Base.

4

Ford Small Block V8.
Fits 221 - 351 cu.in. Ford engines.

4. **FL55** Thermostat Housing Assembly.
4a. **F55** Thermostat Cover.
4b. **F55-G** Gasket, thermostat cover to base.
4c. **143-DEG** Element, 143° for raw water cooling.
4d. **F55C** Thermostat Base.

5

Ford Big Block V8
Fits 429 - 460 cu.in. Ford engines.

5. **FH55** Thermostat Housing Assembly.
5a. **F55H** Thermostat Cover.
5b. **F55-G** Gasket, thermostat cover to base.
5c. **143-DEG** Element, 143° for raw water cooling.
5d. **F55HB** Thermostat Base.

6

Oldsmobile V8
Fits 260 - 455 cu.in. Oldsmobile engines.

6. **OL55** Thermostat Housing Assembly.
6a. **F55O** Thermostat Cover.
6b. **F55-G** Gasket, thermostat cover to base.
6c. **143-DEG** Element, 143° for raw water cooling.
6d. **F55BO-OL** Thermostat Base.