



OEM Style Replacements for: **Log Style**

OMC

GM Small Block V8
305 - 350 cu.in.

1979 to 1989

Necessary pipe plugs are included.

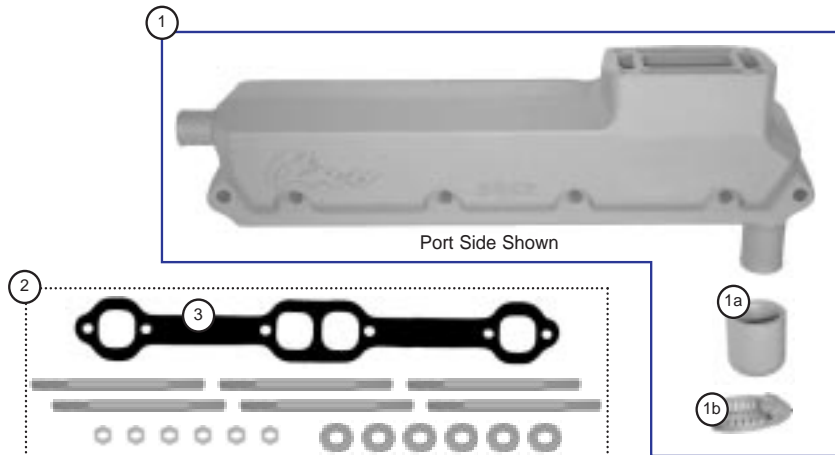
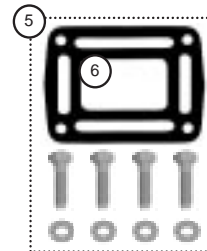

- 1. **2441*** **Manifold, starboard.** Fits 305 - 350 cu.in. GM small block V8 Engines. Includes hose cap and clamp. Replaces OMC #'s 909280 and 912441. Use mounting kit 244-MK.
- 1. **2442*** **Manifold, port.** Fits 305 - 350 cu.in. GM small block V8 Engines. Includes hose cap and clamp. Replaces OMC #'s 910144, 909279, and 912442. Use mounting kit 244-MK.
- 1a. **2228*** **Hose Cap,** 1 1/4" ID. Replaces OMC #'s 909312 and 908488.
- 1b. **C20*** **Hose Clamp,** stainless steel. Fits 2228 hose cap. Replaces OMC # 313851.
- 2. **244-MK** **Mounting Kit,** manifold. Fits 2441 and 2442 manifolds. Includes CV-GH gasket and mounting hardware.
- 3. **CV-GH** **Gasket,** manifold to cylinder head. Included in 244-MK. Replaces OMC #'s 909314 and 3852468.
- 4. **9863** **Riser,** 3 1/2" exhaust outlet 60° down angle. Replaces OMC #'s 909218, 982680 and 909863. Use mounting kit 9863-MK.
- 5. **9863-MK** **Mounting Kit,** riser. Fits 9863 and 9863-T. Includes 9863-G gasket and mounting hardware.
- 6. **9863-G** **Gasket,** riser to manifold. Included in 9863-MK. Replaces OMC # 909786.
- 7. **9863-T** **Riser,** Same as 9863 but tapped to accept 3/4" MPT hose barb. Use mounting kit 9863-MK.

* Items 1a and 1b are included with the manifold.

References to port and starboard are made looking from the rear of the motor forward. Port is left, starboard is right.



Necessary pipe plugs are included.

OEM Style Replacements for:

OMC

Risers used on multiple applications.
Ford and GM.

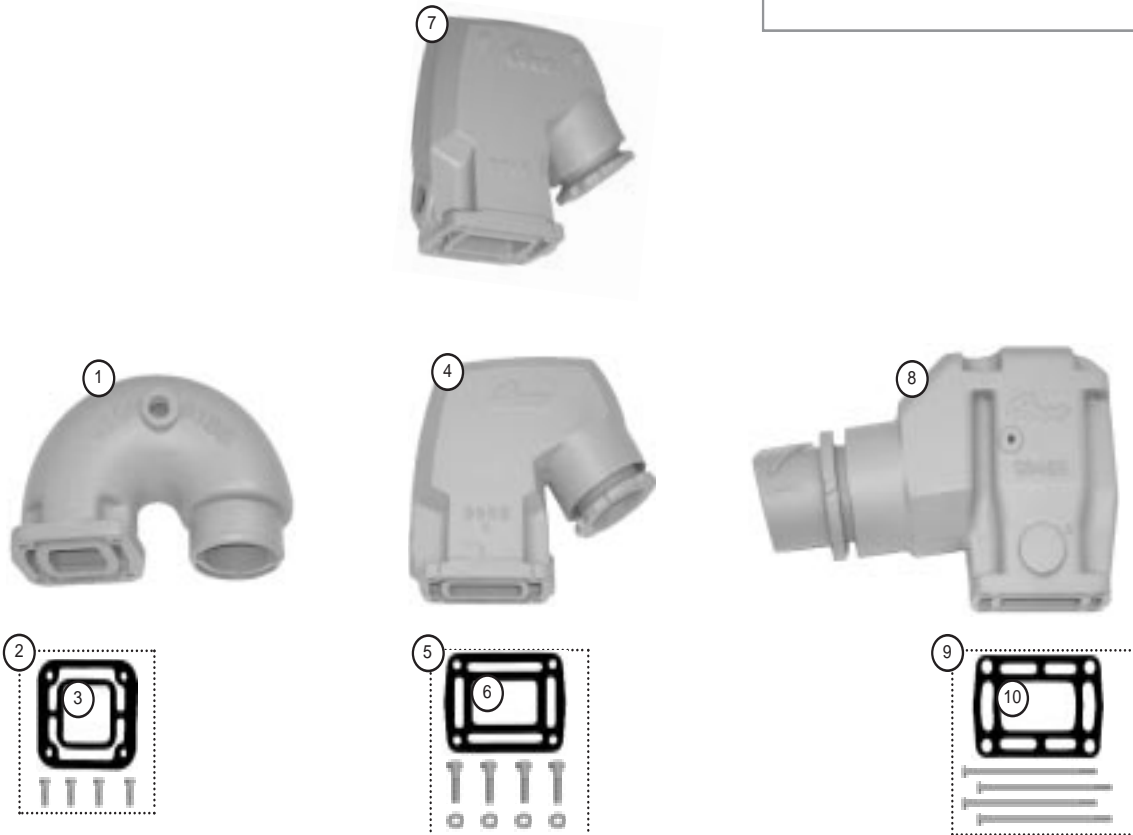

1. **0188** **Riser**, 3³/₈" outlet, 90° down angle. Fits 4 and 6 cylinder inline engines. Replaces OMC #'s 980188 and 980020. Use mounting kit 0188-MK.
2. **0188-MK** **Mounting Kit**, riser. Fits 0188 riser. Includes 0188-G gasket and mounting hardware.
3. **0188-G** **Gasket**, riser to manifold. Included in 0188-MK. Replaces OMC # 908013.
4. **9863** **Riser**, 3¹/₂" exhaust outlet 60° down angle. Fits Ford and GM V8 log style manifolds. Osco does not offer a manifold for OMC Ford applications. Replaces OMC #'s 909218, 982680 and 909863. Use mounting kit 9863-MK.
5. **9863-MK** **Mounting Kit**, Riser. Fits 9863 and 9863-T risers. Includes 9863-G gasket and mounting hardware.
6. **9863-G** **Gasket**, riser to manifold. Included in 9863-MK. Replaces OMC # 909786.
7. **9863-T** **Riser**, Same as 9863 but tapped to accept 3/4" MPT hose barb. Use mounting kit 9863-MK.
8. **50456** **Riser**, 4" exhaust outlet, 7° down angle. Fits Ford and GM V8 center riser style manifolds. Osco does not offer a manifold for OMC Ford applications. Replaces OMC #'s 913784, 3855270 and 3850456.
9. **50456-MK** **Mounting Kit**, riser. Fits 50456 riser. Includes 50456-G gasket and mounting hardware.
10. **50456-G** **Gasket**, riser to manifold. Included in 50456-MK. Replaces OMC # 913783.